



GREEN LANES, LONDON, N16
£325,000 LEASEHOLD

A BRIGHT, ONE DOUBLE BEDROOM
APARTMENT MOMENTS FROM NEWINGTON
GREEN IN N16.

Highbury | 0207 989 7000 | highbury@winkworth.co.uk

Winkworth

winkworth.co.uk

See things differently



DESCRIPTION:

A bright, one bedroom period conversion positioned across the top floor of this Victorian House in N16. Standing close to 400 sqft, the property offers well proportioned rooms throughout and is offered to the market on a chain free basis. The spacious open plan living room kitchen is a good size, while the master bedroom offers wonderful views across East London. The property is completed with the modern shower room.

Situated on Green Lanes this property is conveniently located for an extensive range of local amenities. Newington Green offers a wide array of cafes and restaurants and is well known for its selection of local shops and village atmosphere, as is Stoke Newington's Church Street with its huge array of shops, delis, and eateries.

The open green spaces of Clissold Park are just a short distance away and transport across London is made easy from Canonbury overground station which is only a short distance away as well as numerous bus routes providing easy journeys to the City, Angel and West End.

Winkworth



Winkworth

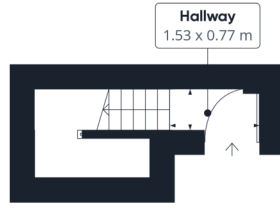

Floor 1

Approximate total area[®]
34.71 m²



Floor 2

Excluding balconies and terraces

While every attempt has been made to ensure accuracy, all measurements are approximate, not to scale. This floor plan is for illustrative purposes only.

GIRAFFE360

This floorplan is for illustration purposes only and is not to scale. The position and size of doors, windows, appliances and other features are approximate.

Highbury | 0207 989 7000 | highbury@winkworth.co.uk

Winkworth

winkworth.co.uk

See things differently

Winkworth wishes to inform prospective buyers and tenants that these particulars are a guide and act as information only. All our details are given in good faith and believed to be correct at the time of printing but they don't form part of an offer or contract. No Winkworth employee has authority to make or give any representation or warranty in relation to this property. All fixtures and fittings, whether fitted or not are deemed removable by the vendor unless stated otherwise and room sizes are measured between internal wall surfaces, including furnishings.