



Winkworth
for every step...



HILL VIEW GARDENS, KINGSBURY, LONDON, NW9
£515,000 FREEHOLD

CHARMING END OF TERRACE FAMILY HOME

Kingsbury | 020 8204 0000 | kingsbury@winkworth.co.uk



for every step...

winkworth.co.uk



Nestled in a prime yet peaceful cul-de-sac perfectly situated midway between Kingsbury and Colindale, this delightful mid terrace house offers a harmonious blend of comfort and convenience. The property features two welcoming reception rooms, ideal for dining, relaxing and entertaining alike, whilst the simplistic kitchen is well equipped for all your culinary needs. Upstairs, you will find two double and one single bedrooms, each providing a serene retreat at the end of the day, as well as a family bathroom. The lovingly maintained rear garden is a true highlight, boasting an abundance of living space perfect for outdoor activities, gardening, or simply unwinding in your private oasis. To the front, a driveway provides the convenience of off-street parking. With huge scope to extend (STPP), this property presents a fantastic opportunity for those looking to create their dream home. Enjoy the perfect balance of tranquillity and accessibility in this sought-after location. Don't miss out on this unique offering – a charming home with endless potential.



Winkworth

for every step...



Winkworth

for every step...

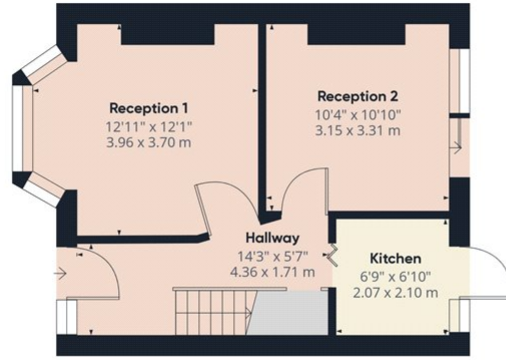

Ground Floor

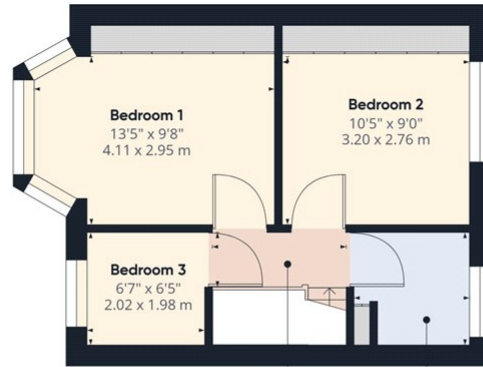

Floor 1

Approximate total area⁽¹⁾
762.23 ft²
70.81 m²

(1) Excluding balconies and terraces

While every attempt has been made to ensure accuracy, all measurements are approximate, not to scale. This floor plan is for illustrative purposes only.

GIRAFFE360

This floorplan is for illustration purposes only and is not to scale. The position and size of doors, windows, appliances and other features are approximate.

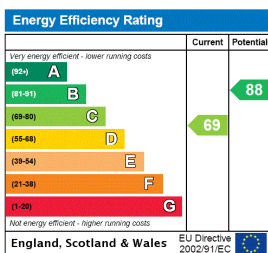

Tenure: Freehold

Council Tax Band: D

Where no figures are shown, we have been unable to ascertain the information. All figures that are shown were correct at the time of printing.

Kingsbury | 020 8204 0000 | kingsbury@winkworth.co.uk

Winkworth

for every step...

winkworth.co.uk

Winkworth wishes to inform prospective buyers and tenants that these particulars are a guide and act as information only. All our details are given in good faith and believed to be correct at the time of printing but they don't form part of an offer or contract. No Winkworth employee has authority to make or give any representation or warranty in relation to this property. All fixtures and fittings, whether fitted or not are deemed removable by the vendor unless stated otherwise and room sizes are measured between internal wall surfaces, including furnishings.