



5 Redward Road, Rownhams, Hampshire, SO16 8JE

Winkworth



DECEPTIVELY SPACIOUS THREE BEDROOM DETACHED BUNGALOW

5 Redward Road is an impressive and spacious three-bedroom detached bungalow with detached garage, located in a popular residential area of Rownhams. Rownhams is a sought-after area perfectly positioned between the city of Southampton and the historic market town of Romsey. On the doorstep is Rownhams Wood an area of natural forest popular with dog walkers. Excellent schools at both primary and secondary level are found within the vicinity, plus easy access to the M27 and M3 motorway networks. Romsey golf club together with the David Lloyd tennis and leisure centre provide excellent leisure facilities whilst The New Forest National Park is a short drive away. A number of popular family friendly public houses to suit all tastes are found locally plus there are several supermarkets conveniently nearby such as Lidl and Sainsburys.

This three-bedroom detached bungalow is in a well-regarded residential area. The accommodation on offer is extremely generous with a large sitting/dining room, three bedrooms and a kitchen/breakfast room. The entrance hallway provides access to all principal rooms. The sitting room with feature fireplace and bay window overlooks the front elevation. The modern kitchen/breakfast room to the rear elevation is fitted with a useful array of floor and wall cupboards with plenty of counter top space. There are three good size bedrooms, two of which benefit from fitted cupboards. Along with the contemporary family shower room, and a separate WC. To the front of the property is a grassed area with the driveway leading to the detached single garage. The rear garden is very private with a large patio area, and lawn, bordered by mature planting.

- Ultrafast Broadband available
- All mains utilities
- Test Valley council tax band 'D' £2,068.20 pa
- No onward chain



Winkworth

**Address: 5 Redward Road,
Rownhams, Southampton SO16 8JE**

**Council Tax Band: 'D' Test Valley BC
EPC: 'C'
Tenure: Freehold**



Ground Floor

Approx. 80.3 sq. metres (864.1 sq. feet)

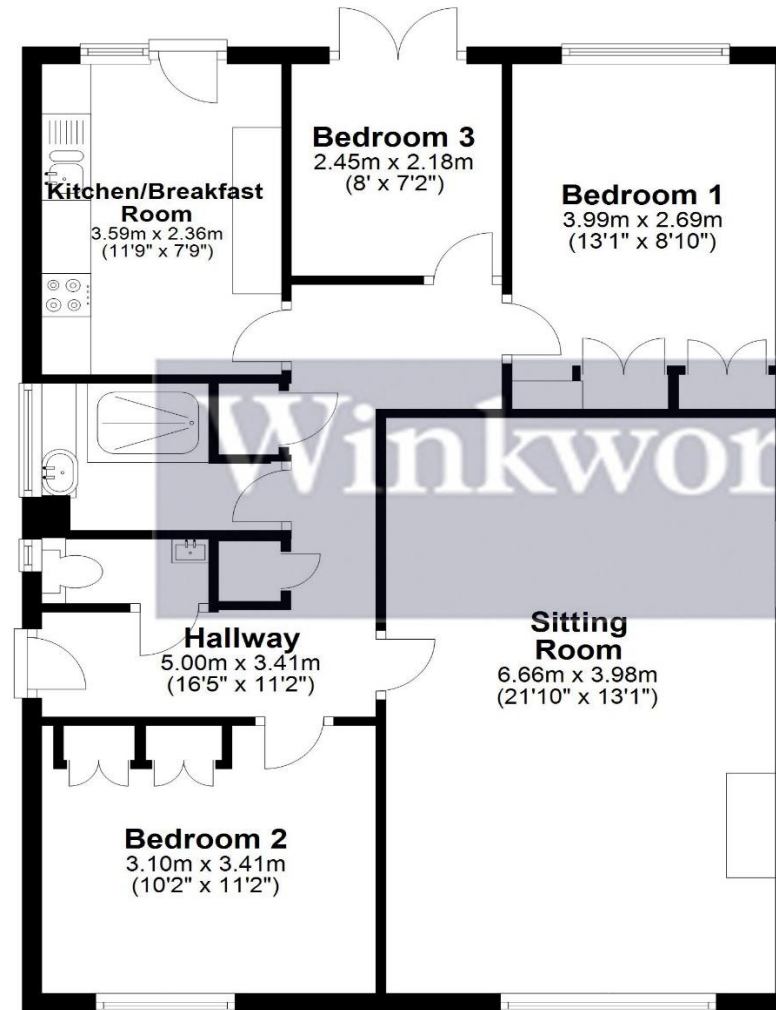

Outbuilding

Approx. 12.0 sq. metres (129.7 sq. feet)

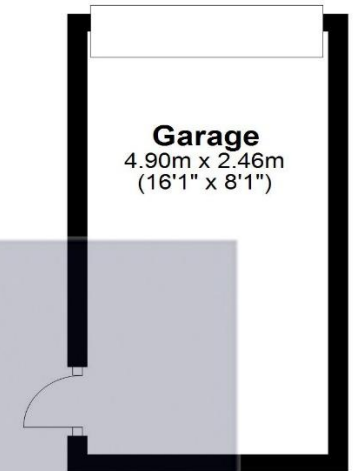

Total area: approx. 92.3 sq. metres (993.8 sq. feet)

winkworth.co.uk/romsey

Winkworth Romsey

18 Market Place, Romsey, Hampshire, SO51 8NA
01794 511911 | romsey@winkworth.co.uk

winkworth.co.uk/romsey

Winkworth Winchester

2 Black Swan Buildings, Southgate Street,
Winchester, Hampshire, SO23 9DT
01962 866777 | winchester@winkworth.co.uk

Winkworth Mayfair & Country House Department

11 Berkeley Street, Mayfair, London, W1J 8DS
020 7871 0589 | countryhouse@winkworth.co.uk

Winkworth

See things differently