



ST. JOHNS ROAD, NW11
£1,000,000 FREEHOLD

A detached corner property, currently as 2 flats

**4/5 BEDROOMS/ 2 KITCHENS/ 2 BATHROOMS/ GREAT POTENTIAL/ CHAIN
FREE/ EPC RATING: D/E/ COUNCIL TAX BAND: D *Garage not included***



DESCRIPTION:

We are delighted to offer this corner detached house with great potential, currently arranged as 2 flats including 2 leases and the Freehold interest.

The property is located on the corner of St Johns Road and Wentworth Road, and is ideally situated both for Golders Green and Temple Fortune. The property is offered with vacant possession however please note the garage to the rear is not included and is not part of the title documents.

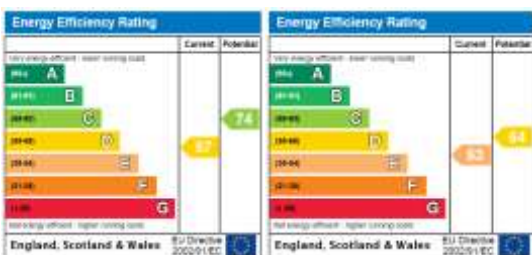



St. Johns Road, London NW11 0PG



Ground Floor
GROSS INTERNAL FLOOR AREA
APPROX. 70.17 SQ M / 755 SQ FT



First Floor
GROSS INTERNAL FLOOR AREA
APPROX. 70.23 SQ M / 756 SQ FT

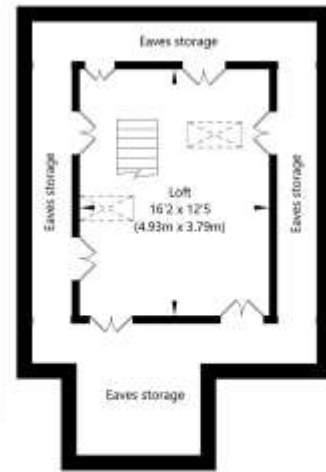

Loft
GROSS INTERNAL FLOOR AREA
APPROX. 18.68 SQ M / 201 SQ FT

APPROXIMATE GROSS INTERNAL FLOOR AREA 159.08 SQ M / 1712 SQ FT
THIS FLOOR PLAN IS FOR ILLUSTRATIVE PURPOSES ONLY AND
SHOULD BE USED FOR THIS PURPOSE BY PROSPECTIVE APPLICANTS AS ITS NOT TO SCALE.