



MACMILLAN WAY, LONDON, SW17
OIEO £450,000 LEASEHOLD

A WELL PRESENTED TWO BEDROOM SECOND FLOOR PURPOSE BUILT FLAT

Tooting | 020 8767 5221 | tooting@winkworth.co.uk

Winkworth

for every step...

winkworth.co.uk



DESCRIPTION:

This well-presented two-bedroom, second-floor flat benefits from abundant natural light throughout. The property is conveniently located near the amenities of both Balham and Tooting Bec.

The flat features a spacious hallway and a reception room that leads to a separate fitted kitchen. The property also includes a large modern bathroom with storage and two double bedrooms, with the master bedroom offering the additional benefit of an en-suite shower room.

Situated on Macmillan Way within Heritage Park, the development includes well-maintained communal areas, communal bike storage, and the services of an on-site caretaker. The property is ideally located near the green open spaces of Tooting Bec Common and the variety of shops, bars, and restaurants along Balham High Road. Tooting Bec Underground Station, a short walk from the property, provides direct links to Waterloo Station.



Macmillan Way, SW17

Approx. Gross Internal Floor Area 637 sq. ft / 59.22 sq. m

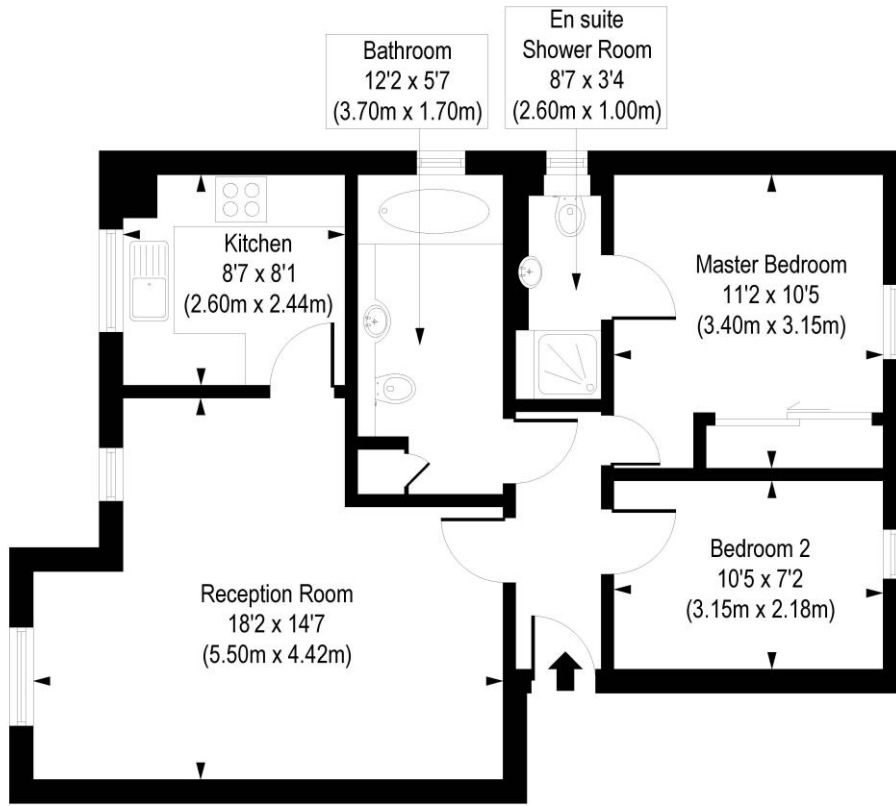
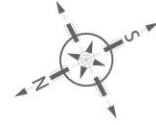

Second Floor

COMPLIANT WITH RICS CODE OF MEASURING PRACTICE. Floorplan is for illustrative purposes only and is not to scale. Every attempt has been made to ensure the accuracy of the floorplan shown, however all measurements, fixtures, fittings and data shown are an approximate interpretation for illustrative purposes only. Liability for errors, omissions or mis-statement through negligence or otherwise is hereby excluded.

This floorplan is for illustration purposes only and is not to scale. The position and size of doors, windows, appliances and other features are approximate.

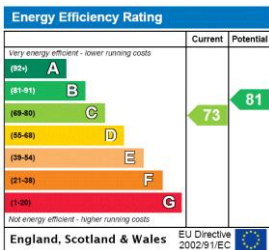

Tooting | 020 8767 5221 | tooting@winkworth.co.uk

for every step...

winkworth.co.uk

Winkworth wishes to inform prospective buyers and tenants that these particulars are a guide and act as information only. All our details are given in good faith and believed to be correct at the time of printing but they don't form part of an offer or contract. No Winkworth employee has authority to make or give any representation or warranty in relation to this property. All fixtures and fittings, whether fitted or not are deemed removable by the vendor unless stated otherwise and room sizes are measured between internal wall surfaces, including furnishings.