



GUERNSEY GROVE, SE24
£1,395 PER MONTH FURNISHED

A BRIGHT ONE DOUBLE BEDROOM FIRST FLOOR FLAT WITHIN THIS MODERN DEVELOPMENT IN HERNE HILL

Herne Hill | 0207 501 8950 | hernehill@winkworth.co.uk

Winkworth

for every step...

winkworth.co.uk



DESCRIPTION:

We are pleased to offer this one double bedroom first floor flat within this modern development. The property is ideally located for the amenities and transport links of Herne Hill with the added bonus of Brockwell Park on the doorstep. This first floor modern flat comprises a good size open plan kitchen reception with modern integrated appliances, a large double bedroom and a modern family bathroom. The property is furnished and available now.

AT A GLANCE

- First Floor Flat
- Modern Development
- One Double Bedroom
- Open-Plan Kitchen/ Reception/ Diner
- Modern Bathroom
- Furnished
- Lambeth Council Tax Band: B
- Available Now





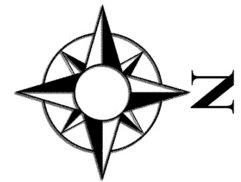
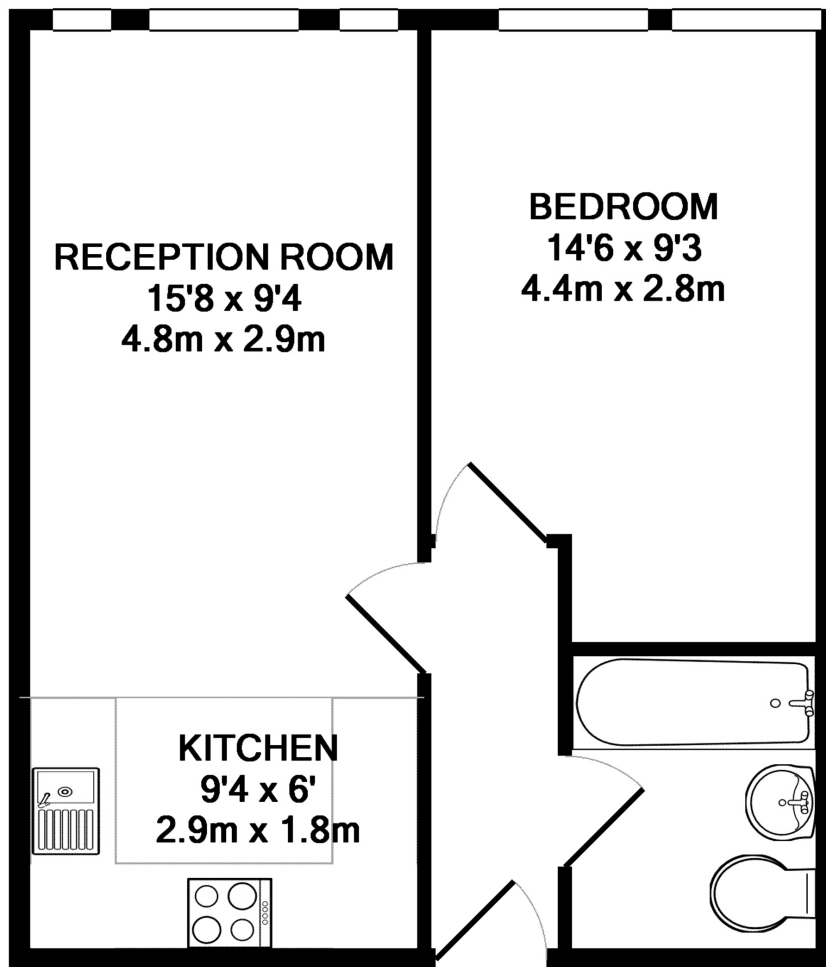

TOTAL APPROX. FLOOR AREA 404 SQ.FT. (37.5 SQ.M.)

Whilst every attempt has been made to ensure the accuracy of the floor plan contained here, measurements of doors, windows, rooms and any other items are approximate and no responsibility is taken for any error, omission, or mis-statement. This plan is for illustrative purposes only and should be used as such by any prospective purchaser. The services, systems and appliances shown have not been tested and no guarantee as to their operability or efficiency can be given

Made with Metropix ©2013

This floorplan is for illustration purposes only and is not to scale. The position and size of doors, windows, appliances and other features are approximate.

Energy Efficiency Rating		Current	Potential
Very energy efficient - lower running costs			
(92-100) A			
(81-91) B			
(69-80) C			
(55-68) D			
(39-54) E			
(21-38) F			
(1-20) G			
Not energy efficient - higher running costs			
England, Scotland & Wales	EU Directive 2002/91/EC	82	82

Herne Hill | 0207 501 8950 | hernehill@winkworth.co.uk



for every step...

winkworth.co.uk

Winkworth wishes to inform prospective buyers and tenants that these particulars are a guide and act as information only. All our details are given in good faith and believed to be correct at the time of printing but they don't form part of an offer or contract. No Winkworth employee has authority to make or give any representation or warranty in relation to this property. All fixtures and fittings, whether fitted or not are deemed removable by the vendor unless stated otherwise and room sizes are measured between internal wall surfaces, including furnishings.