



COLEBROOKE ROW, LONDON, N1  
£625,000 SHARE OF FREEHOLD

# A FANTASTIC TWO BEDROOM FLAT LOCATED ON THE EVER POPULAR COLEBROOKE ROW N1

Islington | 0207 354 2480 | [islington@winkworth.co.uk](mailto:islington@winkworth.co.uk)

**Winkworth**

[winkworth.co.uk](http://winkworth.co.uk)

See things differently



## DESCRIPTION:

Positioned on the first floor of this charming Grade II listed building is this two bedroom property. The flat offers an array of period features including huge sash windows, shutters and high ceilings. Accommodation includes a generous master bedroom, a second bedroom, bathroom, separate kitchen and wonderful reception room. The property further benefits from a share of the freehold and is offered to the market chain free.

Colebrooke Row is exceptionally well located in the heart of Islington and is nestled amongst some of Islington's finest addresses. The property, whilst set amongst peaceful treelined roads, is just a stone's throw from Upper Street and the boutique shops and restaurants on Camden Passage as well as being within easy reach of Regents Canal. Transport links are exceptional with Angel station providing the closest underground links on the Northern line and various overground and underground services provided at Kings Cross.

**Winkworth**



**Winkworth**

# Colebrooke Row, N1

Approx. Gross Internal Floor Area 462 sq. ft / 42.92 sq. m

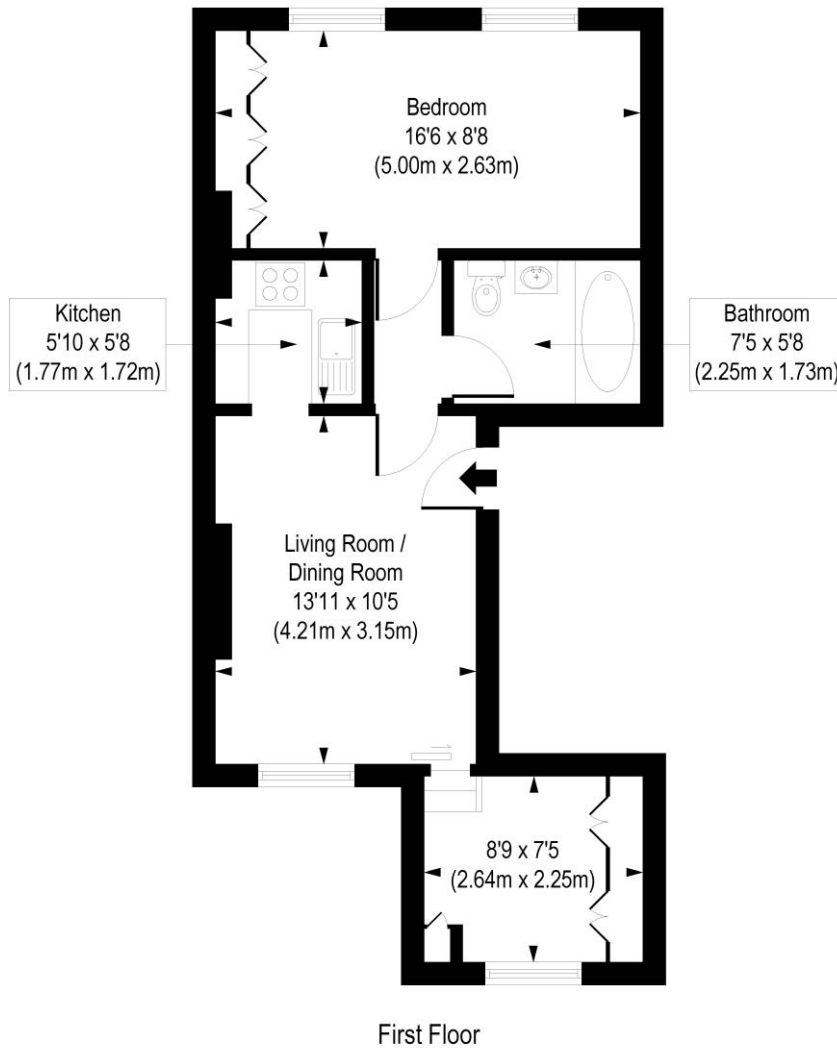

COMPLIANT WITH RICS CODE OF MEASURING PRACTICE. Floorplan is for illustrative purposes only and is not to scale. Every attempt has been made to ensure the accuracy of the floorplan shown, however all measurements, fixtures, fittings and data shown are an approximate interpretation for illustrative purposes only. Liability for errors, omissions or mis-statement through negligence or otherwise is hereby excluded.

This floorplan is for illustration purposes only and is not to scale. The position and size of doors, windows, appliances and other features are approximate.

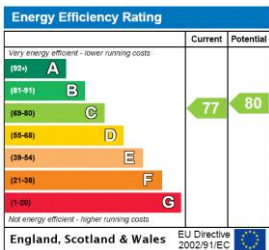

Islington | 0207 354 2480 | islington@winkworth.co.uk



winkworth.co.uk

See things differently

Winkworth wishes to inform prospective buyers and tenants that these particulars are a guide and act as information only. All our details are given in good faith and believed to be correct at the time of printing but they don't form part of an offer or contract. No Winkworth employee has authority to make or give any representation or warranty in relation to this property. All fixtures and fittings, whether fitted or not are deemed removable by the vendor unless stated otherwise and room sizes are measured between internal wall surfaces, including furnishings.