



Cureton Street, UK, SW1P

£2,250 PER MONTH

FURNISHED

AT A GLANCE

- Double Bedroom
- Large Reception
- Modern Kitchen
- Family Bathroom
- 1st Floor
- Council Tax Band C

Winkworth

for every step...



Energy Efficiency Rating		Environmental Impact (CO ₂) Rating	
	Current	Potential	
Very energy efficient - lower running costs			Very environmentally friendly - lower CO ₂ emissions
(92-100) A			(92-100) A
(81-91) B			(81-91) B
(69-80) C			(69-80) C
(55-68) D			(55-68) D
(39-54) E			(39-54) E
(21-38) F			(21-38) F
(1-20) G			(1-20) G
Not energy efficient - higher running costs			Not environmentally friendly - higher CO ₂ emissions
EU Directive 2002/91/EC			EU Directive 2002/91/EC

The energy efficiency rating is a measure of the overall efficiency of a home. The higher the rating the more energy efficient the home is and the lower the fuel bills will be.

The environmental impact rating is a measure of a home's impact on the environment in terms of carbon dioxide (CO₂) emissions. The higher the rating the less impact it has on the environment.

CURETON STREET, UK, SW1P

£2,250 PER MONTH
FURNISHED

A spacious and bright, one double bedroom first floor apartment located in the desirable Millbank Estate. Presented in excellent decorative order throughout.

Accommodation comprises a large comfortable reception with room to dine and entertain, a separate modern fitted kitchen, generous double bedroom with storage and a smart family bathroom.

Further benefits include a recently fitted energy efficient boiler, separate dedicated storage area and private outside storage is available for bikes etc. There is also residents on-street parking outside of the building which is permit free on evenings and weekends.

Wilkie House is located in a quiet backwater and ideally positioned for the shops and restaurants of Victoria Street



winkworth wishes to inform prospective buyers and tenants that these particulars are a guide and act as information only. All our details are given in good faith and believed to be correct at the time of printing but they don't form part of an offer or contract. No winkworth employee has authority to make or give any representation or warranty in relation to this property. All fixtures and fittings, whether fitted or not are deemed removable by the vendor unless stated otherwise and room sizes are measured between internal wall surfaces - including fireplaces.

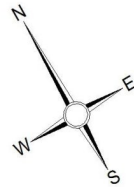

Wilkie House, SW1

Approx. Gross Internal Area
501 Sq Ft - 46.54 Sq M

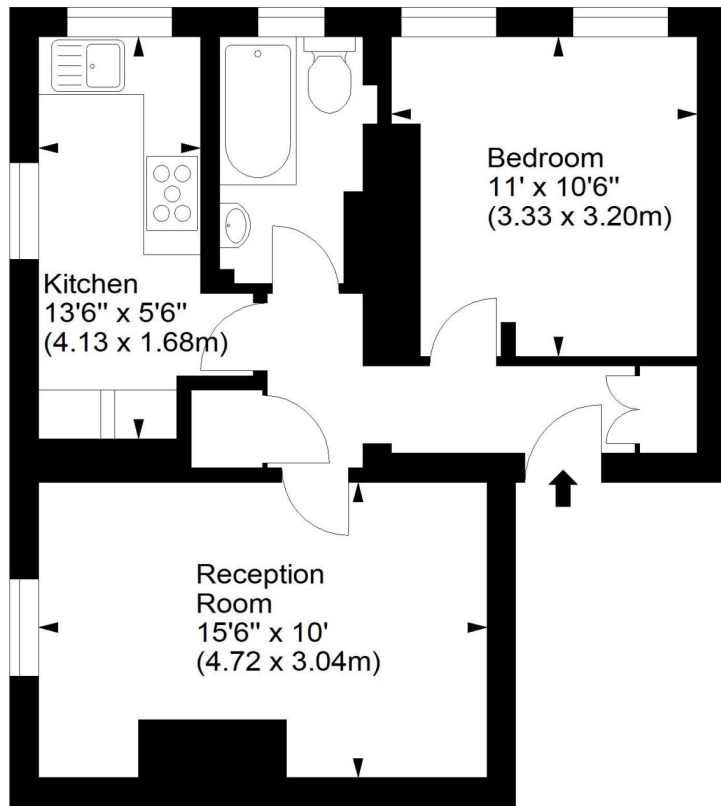

First Floor

For illustration purposes only. Not to scale.
All measurements are taken and shown at floor level.
www.r3photography.co.uk © Photography / Floor Plans / Lease Plans / EPCs

Pimlico & Westminster | 020 7828 1786 |
pimlico@winkworth.co.uk

winkworth.co.uk/pimlico

Winkworth

for every step...