



AMOTT ROAD, PECKHAM RYE, SE15
OIEO £900,000 FREEHOLD

A SPACIOUS THREE-BEDROOM HOUSE SITUATED IN A PRIME PECKHAM RYE LOCATION.

Dulwich | 020 8299 2722 | dulwich@winkworth.co.uk

Tenure Freehold | Council Tax Band D – London Borough of Southwark |

Winkworth

winkworth.co.uk

See things differently



DESCRIPTION:

A spacious three-bedroom house situated in a prime Peckham Rye location, close to both East Dulwich and the Bellenden Road. The property offers three good double bedrooms, a large reception with original flooring, and a family-size kitchen with doors leading out onto a private garden to the rear. The property boasts fantastic scope to extend to the rear and loft, providing an additional two bedrooms or a large master suite STPP. The property is extremely well located and benefits from easy access to the bars, and restaurants on Lordship Lane but also transport links provided via Peckham Rye direct into Central London and beyond. This is a fantastic house that would suit a family looking for plenty of space and a high specification throughout.

AT A GLANCE

- Three Bedrooms
- Terraced House
- Large Reception Room
- Separate Kitchen
- Bath & Shower Room
- Garden
- Potential to Extend STPP
- Excellent Location





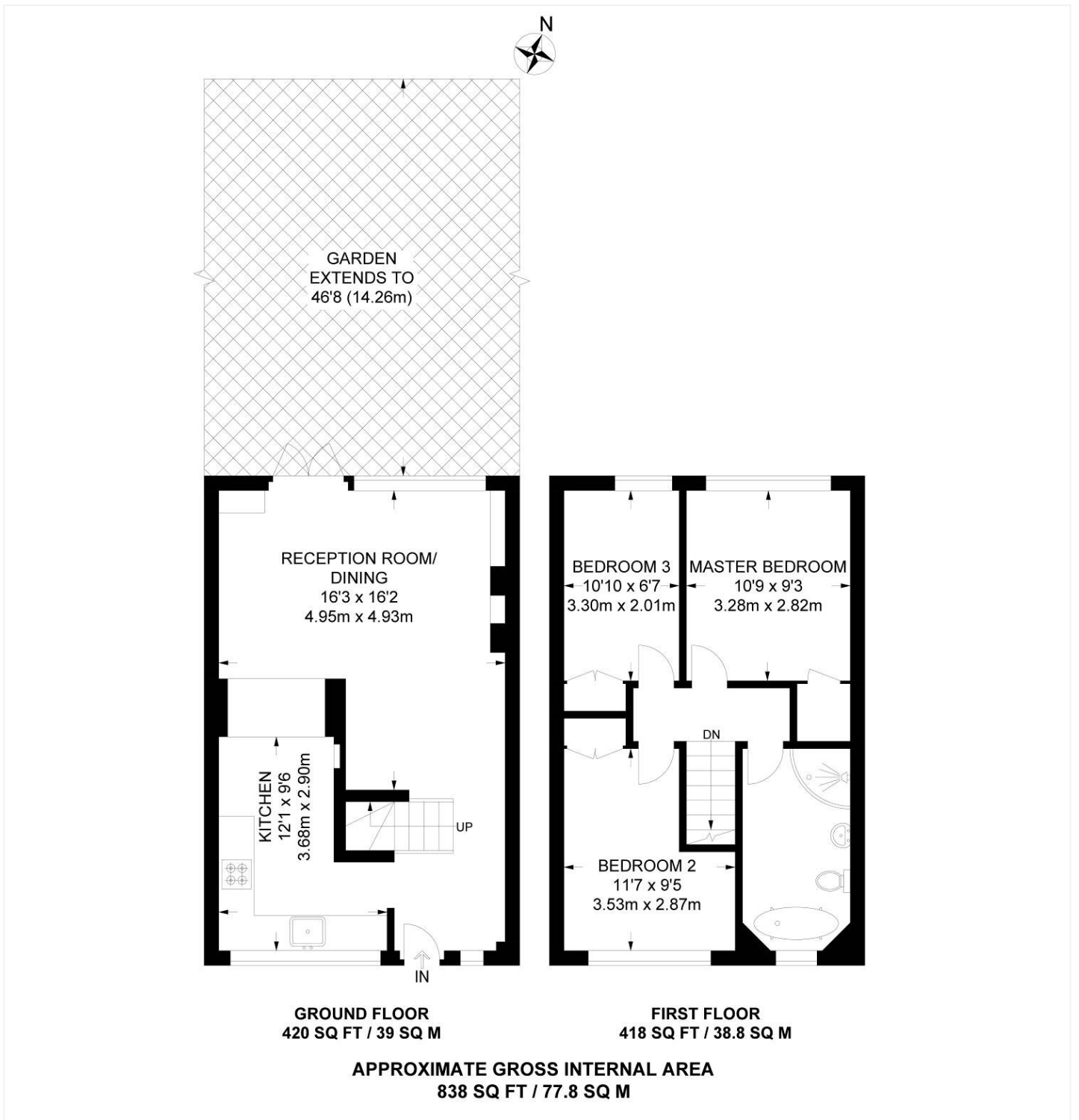

This floorplan is for illustration purposes only and is not to scale. The position and size of doors, windows, appliances and other features are approximate.

Dulwich | 020 8299 2722 | dulwich@winkworth.co.uk



winkworth.co.uk

See things differently

Winkworth wishes to inform prospective buyers and tenants that these particulars are a guide and act as information only. All our details are given in good faith and believed to be correct at the time of printing but they don't form part of an offer or contract. No Winkworth employee has authority to make or give any representation or warranty in relation to this property. All fixtures and fittings, whether fitted or not are deemed removable by the vendor unless stated otherwise and room sizes are measured between internal wall surfaces, including furnishings.