



HABERDASHER STREET, LONDON, N1
£825,000 FREEHOLD

**A THREE BEDROOM, TWO RECEPTION ROOM,
END OF TERRACE TOWNHOUSE WITH SOUTH
FACING GARDEN.**

Shoreditch | 020 7749 7650 | shoreditch@winkworth.co.uk





DESCRIPTION:

A rare to the market 1246 sq. ft. end of terrace, 3 bedrooms, 2 bathrooms townhouse with drive, garage, and private garden on the leafy and residential Haberdasher Street near Old Street underground station, Curzon cinema and Shoreditch Park.

The property comprises of a drive, garage, entrance hall, downstairs W.C and kitchen/ dining space that leads to the south facing private garden. On first floor comprises of a larger than average utility room, WC, standing shower, office space, and living room whereas the second floor comprises of three bedrooms, shower room and separate WC.

Haberdasher Street is in the heart of fashionable Hoxton and a short distance away from the green spaces of Shoreditch Park and Regents Canal. Old Street Station (Northern Line) is the closest station with Hoxton Overground close by, both providing great access across London. You are spoilt for choice when it comes to local amenities with a cinema and an array of shops, pop ups, cafes, bars and restaurants along Hoxton Street, Pitfield Street, Old Street, Shoreditch High Street and Commercial Street where you will find the famous Spitalfields market.

Winkworth



Winkworth

Haberdasher Street, N1

Approx. Gross Internal Floor Area 1246 sq. ft / 115.73 sq. m (Including Garage)

Approx. Gross Internal Floor Area 1119 sq. ft / 103.97 sq. m (Excluding Garage)

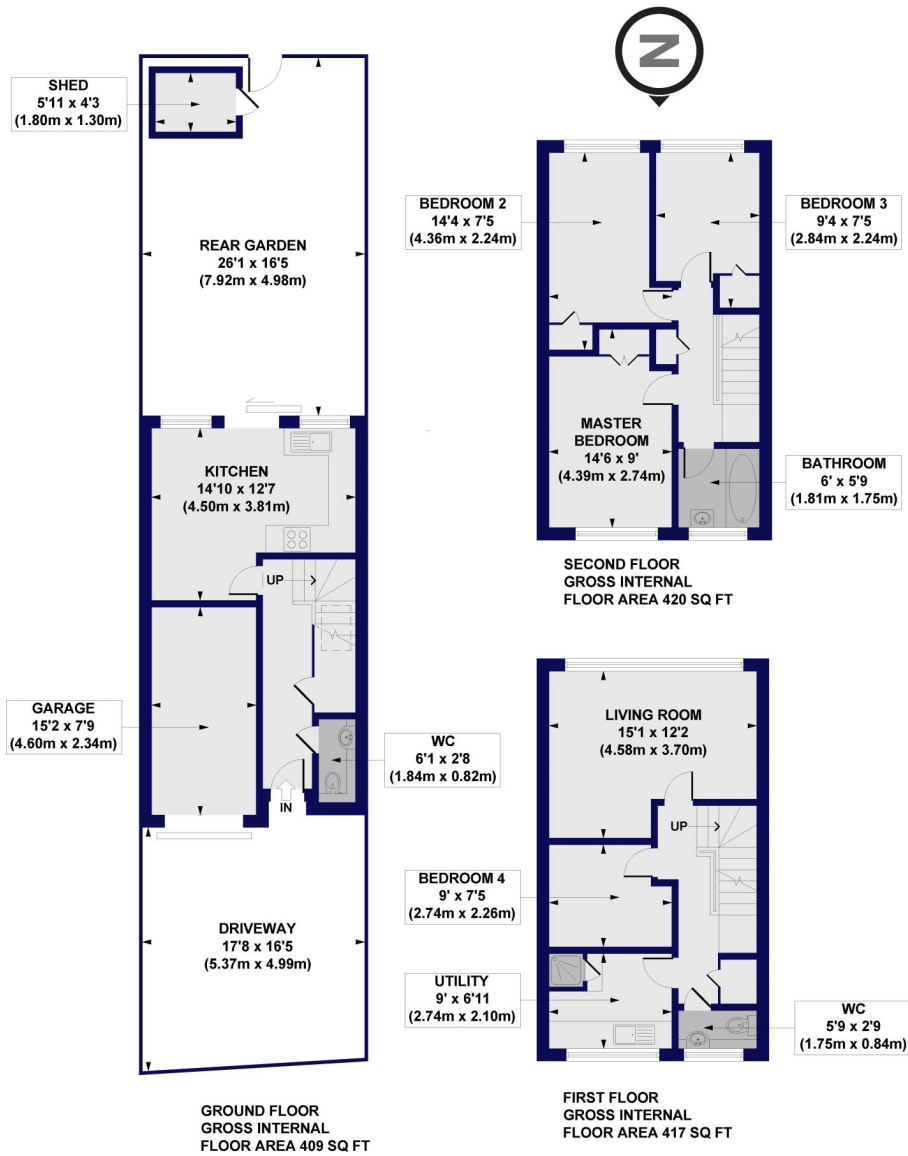

All measurements of walls, doors, windows, fittings and appliances, including their size and location, are shown as standard sizes and do not constitute any warranty or representation by the seller, their agent or CP Creative. Any intending purchaser must satisfy himself by inspection or otherwise as to the correctness of the information contained in these plans. This plan is for illustrative purposes only and should be used as such by any prospective purchasers.

Winkworth

This floorplan is for illustration purposes only and is not to scale. The position and size of doors, windows, appliances and other features are approximate.

Shoreditch | 020 7749 7650 | shoreditch@winkworth.co.uk



winkworth.co.uk

See things differently

Winkworth wishes to inform prospective buyers and tenants that these particulars are a guide and act as information only. All our details are given in good faith and believed to be correct at the time of printing but they don't form part of an offer or contract. No Winkworth employee has authority to make or give any representation or warranty in relation to this property. All fixtures and fittings, whether fitted or not are deemed removable by the vendor unless stated otherwise and room sizes are measured between internal wall surfaces, including furnishings.