



STREATHAM HILL, SW2
£1,850 PER MONTH UNFURNISHED

A SUPERB TWO DOUBLE BEDROOM TOP FLOOR MANSION APARTMENT IN PRIME STREATHAM HILL

Streatham | 020 8769 6699 | streatham@winkworth.co.uk

Winkworth

for every step...

winkworth.co.uk



DESCRIPTION:

Available exclusively through Winkworth, we are delighted to offer to let this bright, top floor mansion apartment in good condition which offers over 875 sq. Ft. of living space. The property is accessed via a heavy wooden communal street door and there is a wide internal staircase and lift. The apartment's L-shaped entrance hall has good quality engineered wood flooring from which all the accommodation is accessed: to the front of the property there is a generous 18'2" living room with large windows (with secondary glazing to insulate from street noise) and southerly views over Streatham Hill. Next to this is the second double bedroom which is bright and airy with south-facing light pouring in and has a fitted closet. The principal double bedroom is generously proportioned (15'10" by 12'5") and overlooks the rear of the property via a large window with lovely views over the London skyline. The adjacent tiled bathroom also has a window and is equipped with a bath and shower, a wash hand basin, a WC and a heated towel rail. The galley kitchen has plenty of fitted cabinet and worktop space running along both walls and the sink is positioned under the window. Transport at Streatham Hill (London Victoria in 17 minutes) is walking distance and Brixton Tube is a short bus ride down the hill. On the doorstep there are all the local amenities including many lively independent shops, cafes and restaurants. Hillside Gardens park is at the top of the Barcombe and Amesbury Avenues and both Streatham and Tooting Bec Commons are also within easy reach. Available from the 01st of February 2024 on an unfurnished/part furnished basis (wardrobe and mirror are the only items remaining).

AT A GLANCE

- Mansion Apartment
- Top Floor (Fourth with lift)
- Reception Room
- Kitchen
- Two Double Bedrooms
- Bathroom
- Unfurnished/Part Furnished (wardrobe and mirror will remain)
- Available 01st of February 2024





Wyatt Park Mansions, Streatham Hill, SW2

Approximate Floor Area = 81.5 sq m / 877 sq ft
Including Limited Use Area (1.7 sq m / 18 sq ft)

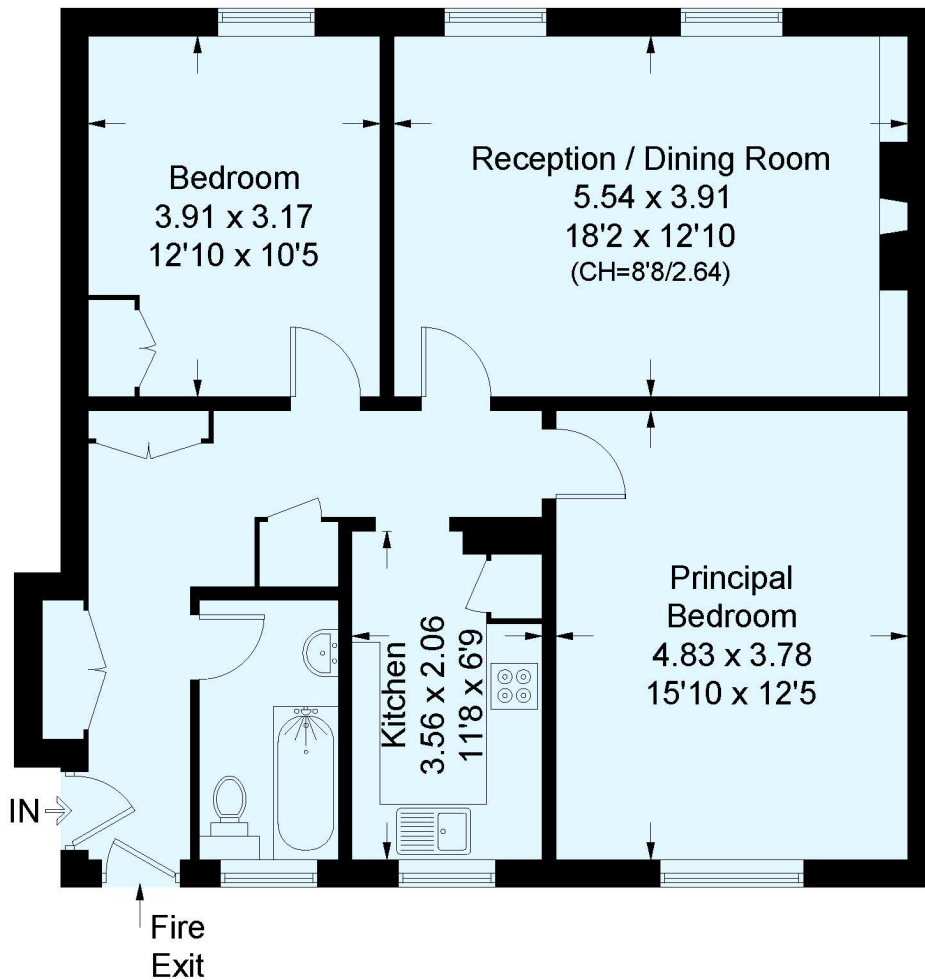

Fourth Floor

This plan is for layout guidance only. Not drawn to scale unless stated. Windows and door openings are approximate. Whilst every care is taken in the preparation of this plan, please check all dimensions, shapes and compass bearings before making any decisions reliant upon them. (ID713907)

This floorplan is for illustration purposes only and is not to scale. The position and size of doors, windows, appliances and other features are approximate.

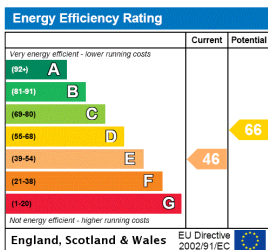

Streatham | 020 8769 6699 | streatham@winkworth.co.uk



for every step...

winkworth.co.uk

Winkworth wishes to inform prospective buyers and tenants that these particulars are a guide and act as information only. All our details are given in good faith and believed to be correct at the time of printing but they don't form part of an offer or contract. No Winkworth employee has authority to make or give any representation or warranty in relation to this property. All fixtures and fittings, whether fitted or not are deemed removable by the vendor unless stated otherwise and room sizes are measured between internal wall surfaces, including furnishings.