



NETHER STREET, LONDON, N3  
£880,000 FREEHOLD

## A NATURAL FOUR BEDROOM SEMI- DETACHED FAMILY HOME

Finchley | 020 8349 3388 | [finchley@winkworth.co.uk](mailto:finchley@winkworth.co.uk)

**Winkworth**

for every step...

[winkworth.co.uk](http://winkworth.co.uk)



## DESCRIPTION:

We are pleased to offer this well-presented natural four bedroom semi-detached family home, situated within walking distance to Finchley Central Tube Station, bus links, shopping amenities, St Mary's Primary School and recreational parkland, such as Dollis Valley Greenwalk and Stephens House & Gardens. To the ground floor the property comprises of through-lounge, kitchen and downstairs wc. To the first floor there are four bedrooms, family bathroom and separate wc. Further benefits include off street parking, rear garden with outbuilding and potential to expand further (stpp). Offered on a chain free basis. An internal viewing is highly recommended.

NB The property adjoins land owned by TFL, over which a garden licence was granted. TFL have recently confirmed in writing a garden licence will be issued to the new owner and that TFL have no intention of removing the licence or using the land for the foreseeable future.

## AT A GLANCE

- Ideally located
- Semi-detached family home
- Four bedrooms
- Through-lounge
- Fitted kitchen
- Downstairs wc
- Off street parking & Garage
- Offered chain free





# Nether Street, N3

Approx. Gross Internal Floor Area 1453 sq. ft / 134.95 sq. m (Including Out Building)

Approx. Gross Internal Floor Area 1279 sq. ft / 118.85 sq. m (Excluding Out Building)

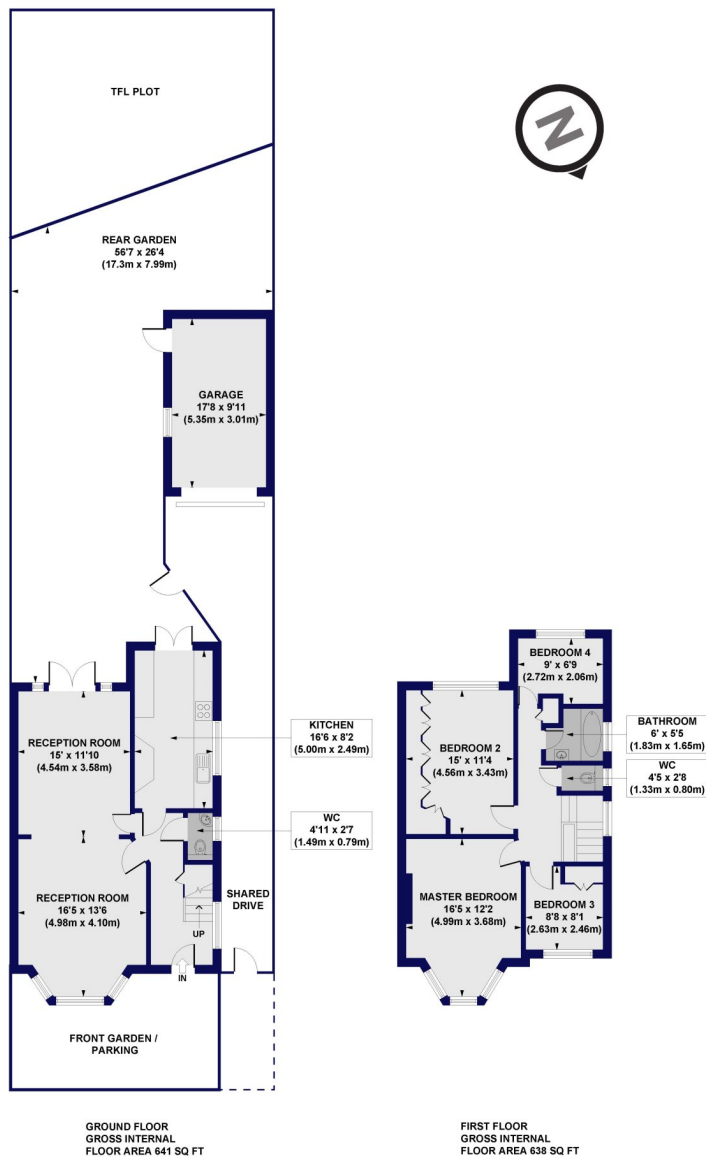

All measurements of walls, doors, windows, fittings and appliances, including their size and location, are shown as standard sizes and do not constitute any warranty or representation by the seller, their agent or CP Creative. Any intending purchaser must satisfy himself by inspection or otherwise as to the correctness of the information contained in these plans. This plan is for illustrative purposes only and should be used as such by any prospective purchasers.

This floorplan is for illustration purposes only and is not to scale. The position and size of doors, windows, appliances and other features are approximate.

Council Tax Band: F

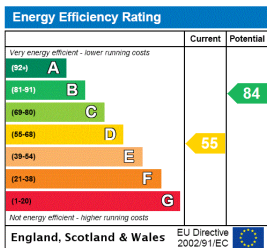

Finchley | 020 8349 3388 | finchley@winkworth.co.uk

for every step...

winkworth.co.uk

Winkworth wishes to inform prospective buyers and tenants that these particulars are a guide and act as information only. All our details are given in good faith and believed to be correct at the time of printing but they don't form part of an offer or contract. No Winkworth employee has authority to make or give any representation or warranty in relation to this property. All fixtures and fittings, whether fitted or not are deemed removable by the vendor unless stated otherwise and room sizes are measured between internal wall surfaces, including furnishings.