



**SUTHERLAND HOUSE, ROYAL HERBERT PAVILLIONS, LONDON, SE18 4PS
GUIDE PRICE £300,000-£325,000 SHARE OF FREEHOLD**

A STYLISH AND MUCH IMPROVED ONE DOUBLE BEDROOM APARTMENT FOUND ON THE GROUND FLOOR OF THE HISTORIC ROYAL HERBERT PAVILION. SOLD CHAIN FREE AND SET IN SEVEN ACRES OF GROUNDS WITH A FITNESS CENTRE, SWIMMING POOL AND TENNIS COURTS.

Blackheath | 0208 8520999 | blackheath@winkworth.co.uk

Winkworth

winkworth.co.uk

See things differently



DESCRIPTION:

The accommodation comprises a good size reception room, a separate and attractive modern kitchen with integrated appliances including washer/dryer and dishwasher. There is a large master bedroom and a beautiful modern wet room. The property is in excellent good decorative order with large sash windows, Amtico flooring and gas fired central heating. The property further benefits from a parking space and is sold chain free and with a share in the freehold.

This is an impressive apartment and your immediate viewing is a must.

The historic grade II listed Royal Herbert Pavilions is a sought after private development. It is a conversion of the old military hospital which was built in 1865. Features of the development include the use of fitness centre, an indoor swimming pool, jacuzzi, sauna, gymnasium, tennis court, residents bar to relax in and vast landscaped communal gardens.

The Royal Herbert Pavilions is a 12mins bus ride to Woolwich Overground, DLR and newly opened Elizabeth Line Stations, giving access to Central London, Canary Wharf, and City, Luton and Heathrow Airports. There are additional routes from Kidbrooke Rail Station (10mins bus), Eltham Rail Station (7mins bus) and 15mins bus to picturesque Blackheath with its array of boutiques, bars, restaurants, and rail Station. Also, there is a new chariot shuttle minibus service to North Greenwich Jubilee line from Shooters Hill. The ancient 8,000 year old Oxleas Woods, which houses Severndroog Castle with excellent views of London is just across the road.

AT A GLANCE

- historic development
- Grade II listed
- one double bedroom
- ground floor
- excellent condition
- share of freehold
- chain free
- seven acres of grounds
- tennis court
- gym and fitness
- swimming pool





Ground Floor

Approx. 41.4 sq. metres (445.5 sq. feet)

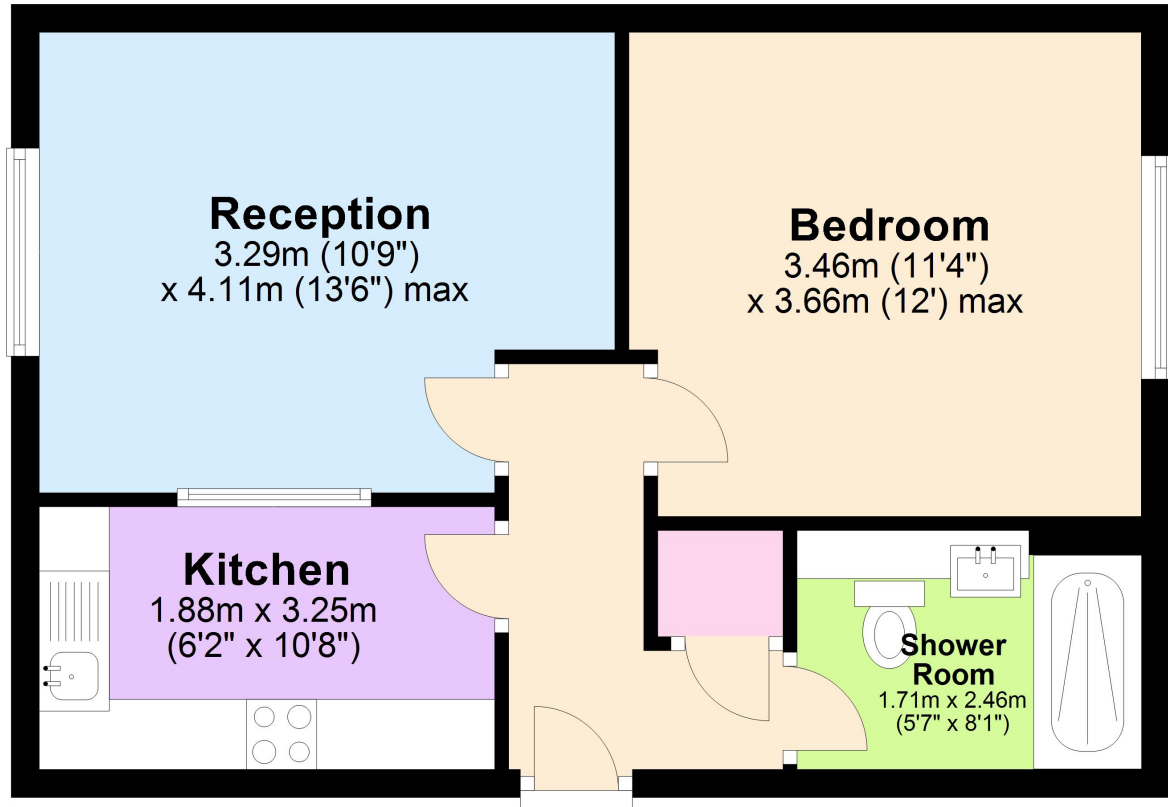

Total area: approx. 41.4 sq. metres (445.5 sq. feet)

This floorplan is for illustration purposes only and is not to scale. The position and size of doors, windows, appliances and other features are approximate. Any lease and service charge details have been provided by the vendor. Any interest party should have these checked by a solicitor as part of the purchase process.

Blackheath | 0208 8520999 | blackheath@winkworth.co.uk

Winkworth

winkworth.co.uk

See things differently

Winkworth wishes to inform prospective buyers and tenants that these particulars are a guide and act as information only. All our details are given in good faith and believed to be correct at the time of printing but they don't form part of an offer or contract. No Winkworth employee has authority to make or give any representation or warranty in relation to this property. All fixtures and fittings, whether fitted or not are deemed removable by the vendor unless stated otherwise and room sizes are measured between internal wall surfaces, including furnishings.