



7 Longacre, Newbury, RG14 6DZ

Winkworth



7 Longacre

Newbury, RG14 6DZ

A beautifully presented four bedroom detached family home set within St. Barts catchment with NO ONWARD CHAIN

This fantastic family home has a large entrance hallway, with a modern kitchen providing a breakfast bar, a downstairs W/C and shower room, a spacious dining room with neutral decor and a stunning living room with a large bay window, keeping this room bright and airy as well as a gas fireplace.

Upstairs are four great sized bedrooms. Three of which have views over fields. The family bathroom is modern and has a shower over the bath.

The south facing garden is very generous, as the house sits on a prime corner plot. There is a patio area immediately to the back of the house. The rest of the garden is mainly laid to lawn.

To the side of the house, you have a single detached garage with power and a driveway. The front garden is all laid to lawn and again, generous in size.

EPC D

Council Tax Band E

AT A GLANCE

- 1078ft/101m²
- Three double bedrooms
- Single bedroom
- Family bathroom with shower over bath
- Downstairs w/c / Shower room
- Sitting room
- Dining room
- Kitchen
- Detached Garage with power
- Off road parking
- Generous garden
- Brand new Worcester boiler

UTILITIES

Mains water, electricity and drainage.

Gas central heating.

DIRECTIONS

For Sat Nav use RG14 6DZ

What 3 Words///pretty.needed.chill

SITUATION

7 Longacre is situated in a small close of similar houses a short walk from St. Barts secondary school. You are also approximately 1 mile from the Newbury center and Newbury train station.





Longacre, Newbury, RG14

Approximate Area = 1078 sq ft / 100.1 sq m

Garage = 144 sq ft / 13.4 sq m

Total = 1222 sq ft / 113.5 sq m

For identification only - Not to scale

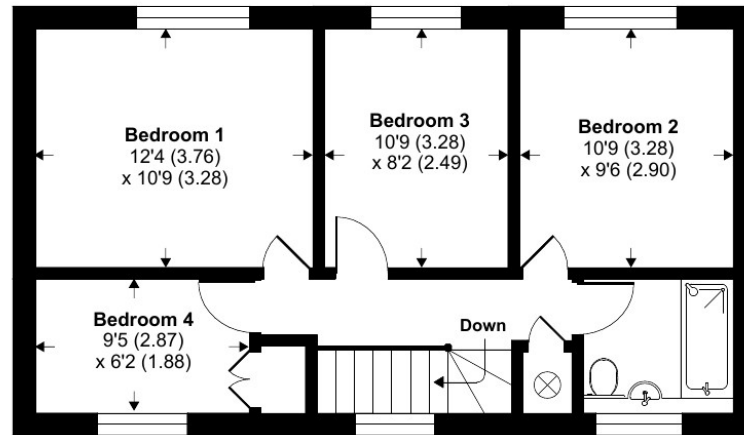

FIRST FLOOR

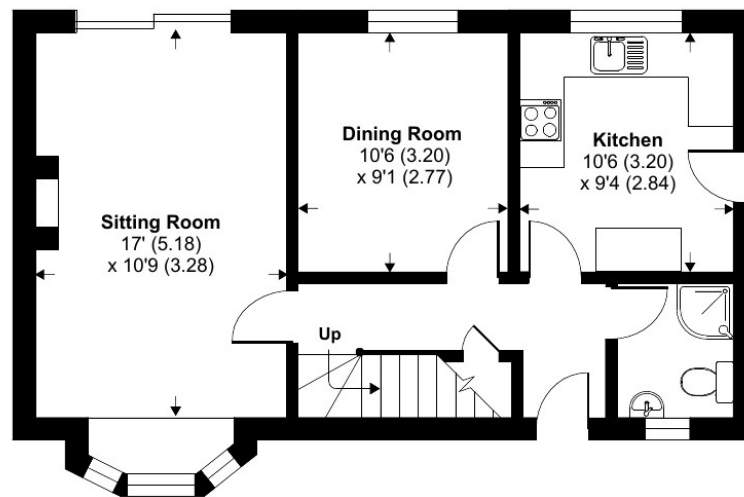

GROUND FLOOR

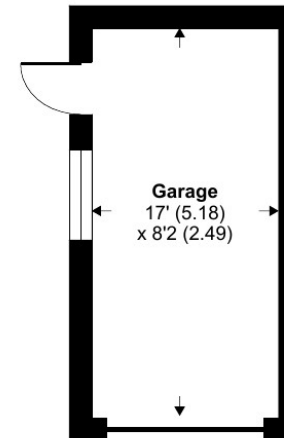

Newbury Office

43 Northbrook Street, Newbury, Berkshire RG14 1DT

01635 552552 | newbury@winkworth.co.uk

winkworth.co.uk/newbury

Winkworth

See things differently.