



MYDDLETON AVENUE, LONDON, N4  
£925,000 FREEHOLD

## A 3 BEDROOM TOWN HOUSE

Highbury | 0207 989 7000 | [highbury@winkworth.co.uk](mailto:highbury@winkworth.co.uk)

**Winkworth**

[winkworth.co.uk](http://winkworth.co.uk)

See things differently



## DESCRIPTION:

The total accommodation is set over three-levels and occupies 1371Sq.ft / 127.37 Sq.m including storage on each landing.

The interior spaces have been lovingly renovated by the current owners over the years to create a home that is perfectly suited to modern life.

Behind the modern facade you'll find a tiled entrance hall. The ground floor is occupied by a garage at the front, the living/kitchen diner opens on to a mature sunny back garden.

Over the first floor you have a light-filled living room, a fantastic room for entertaining family and friends. You will also find bedroom three and a family bathroom on this landing. Up above and set on the top floor is the master bedroom and bedroom two and a modern shower room servicing these two rooms.

Found within one mile of the amenities of the prestigious Highbury Barn. The green open spaces of Clissold Park, Finsbury Park, Highbury Fields and the Woodberry Wetlands nature reserve are all close by, as well as top-notch sports facilities of the West Reservoir and the Castle Climbing Centre. The bars and

**Winkworth**



**Winkworth**

## Myddleton Avenue, N4

Approx. Gross Internal Floor Area 1371 sq. ft / 127.37 sq. m (Including Summer House & Garage)

Approx. Gross Internal Floor Area 1161 sq. ft / 107.88 sq. m (Excluding Summer House & Garage)

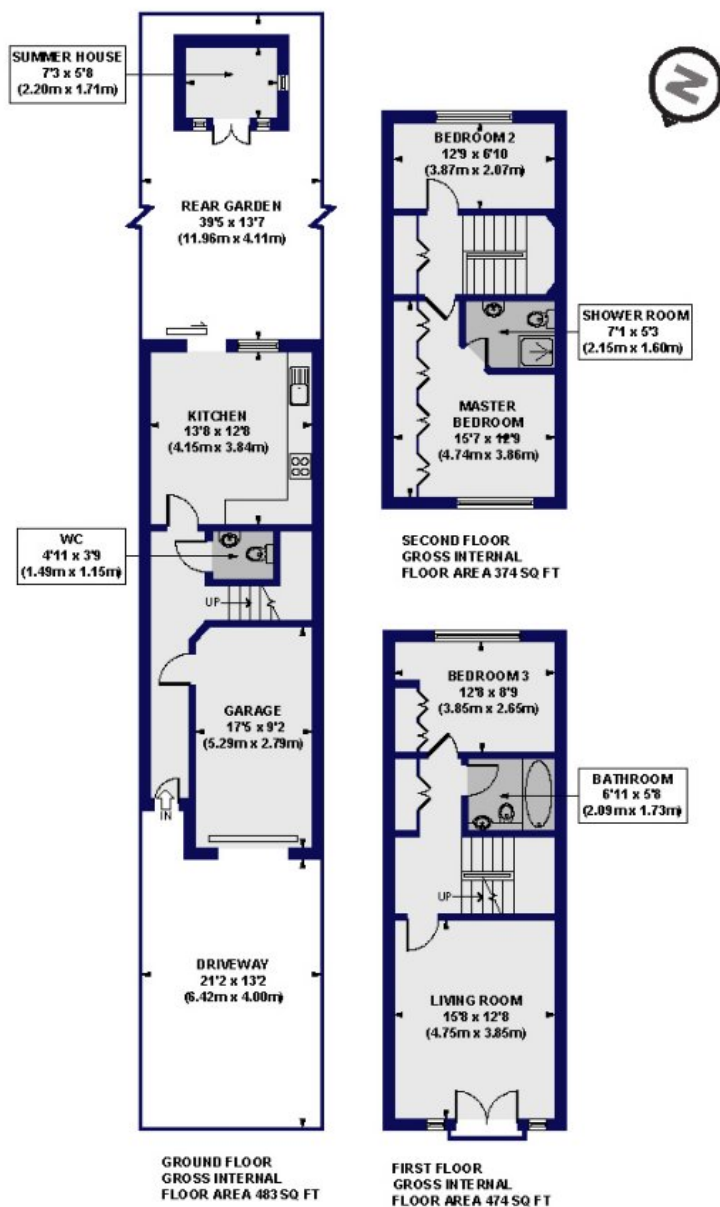

All measurements of walls, doors, windows, fittings and appliances, including their size and location, are shown as standard sizes and do not constitute any warranty or representation by the seller, their agent or CP Creative. Any intending purchaser must satisfy himself by inspection or otherwise as to the correctness of the information contained in these plans. This plan is for illustrative purposes only and should be used as such by any prospective purchasers.

**Winkworth**

This floorplan is for illustration purposes only and is not to scale. The position and size of doors, windows, appliances and other features are approximate.

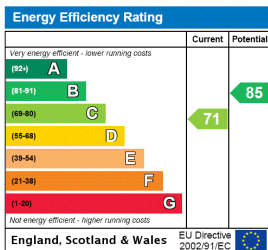

Highbury | 0207 989 7000 | highbury@winkworth.co.uk

**Winkworth**

winkworth.co.uk

See things differently

Winkworth wishes to inform prospective buyers and tenants that these particulars are a guide and act as information only. All our details are given in good faith and believed to be correct at the time of printing but they don't form part of an offer or contract. No Winkworth employee has authority to make or give any representation or warranty in relation to this property. All fixtures and fittings, whether fitted or not are deemed removable by the vendor unless stated otherwise and room sizes are measured between internal wall surfaces, including furnishings.