



MARTINS WALK, HERTFORDSHIRE, WD6
£395,000 FREEHOLD

A CHAIN FREE TWO BEDROOM HOUSE IN SOUTH BOREHAMWOOD

Borehamwood | 020 8953 8899 | borehamwood@winkworth.co.uk



Winkworth

DESCRIPTION:

Positioned in a quiet and desirable location, less than 400 metres walk from both Borehamwood's bustling High Street and the Thameslink station with its speedy link into central London is this two bedroom terrace house.

Offered for sale chain free the property benefits from an allocated parking space nearby and would be ideal for a first time buyer, downsizer or buy to let investor.

AT A GLANCE

- 2 Bedrooms
- Chain Free
- Southerly Rear Garden
- South Borehamwood
- 537 Square Feet
- Allocated Parking Space
- Double Glazed



Winkworth



Winkworth



Winkworth



Winkworth



Winkworth



Winkworth



Winkworth

Approximate Gross Internal Area = 49.9 sq m / 537 sq ft

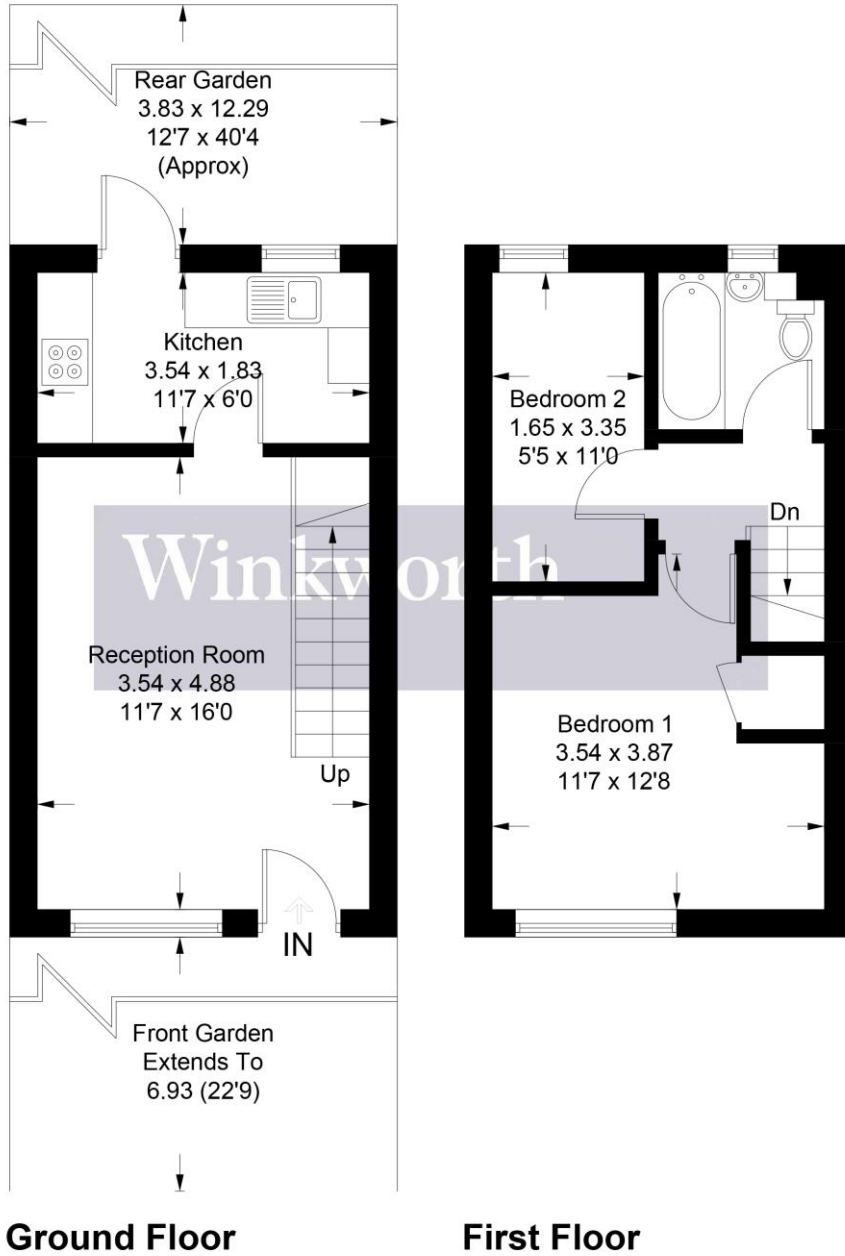

Illustration for identification purposes only, measurements are approximate, not to scale. Winkworth © 2024 (ID1043235)

This floorplan is for illustration purposes only and is not to scale. The position and size of doors, windows, appliances and other features are approximate.

