



GUERNSEY GROVE, LONDON, SE24
£1,400 PER MONTH FURNISHED

A MODERN GROUND FLOOR ONE DOUBLE BEDROOM FLAT IDEALLY LOCATED IN CENTRAL HERNE HILL

DESCRIPTION

The property comprises a good size open plan modern kitchen reception diner (gas hob, electric oven, under counter fridge, under counter freezer and washing machine), a double bedroom with a modern en-suite shower room with a WC and a separate WC. The property is furnished and available from the 18th of October 2023.

AT A GLANCE

- Ground Floor Modern Flat
- One Double Bedroom
- En-Suite Bathroom with WC
- Separate WC
- Good size open plan kitchen reception diner
- Furnished
- Available 18th October 2023
- Lambeth Council Tax Band: B

Herne Hill | 0207 501 8950 | hernehill@winkworth.co.uk

Winkworth

for every step...

winkworth.co.uk

The Old Bread House, Guernsey Road, SE24

Approximate Gross Internal Area
40.1 sq m / 432 sq ft

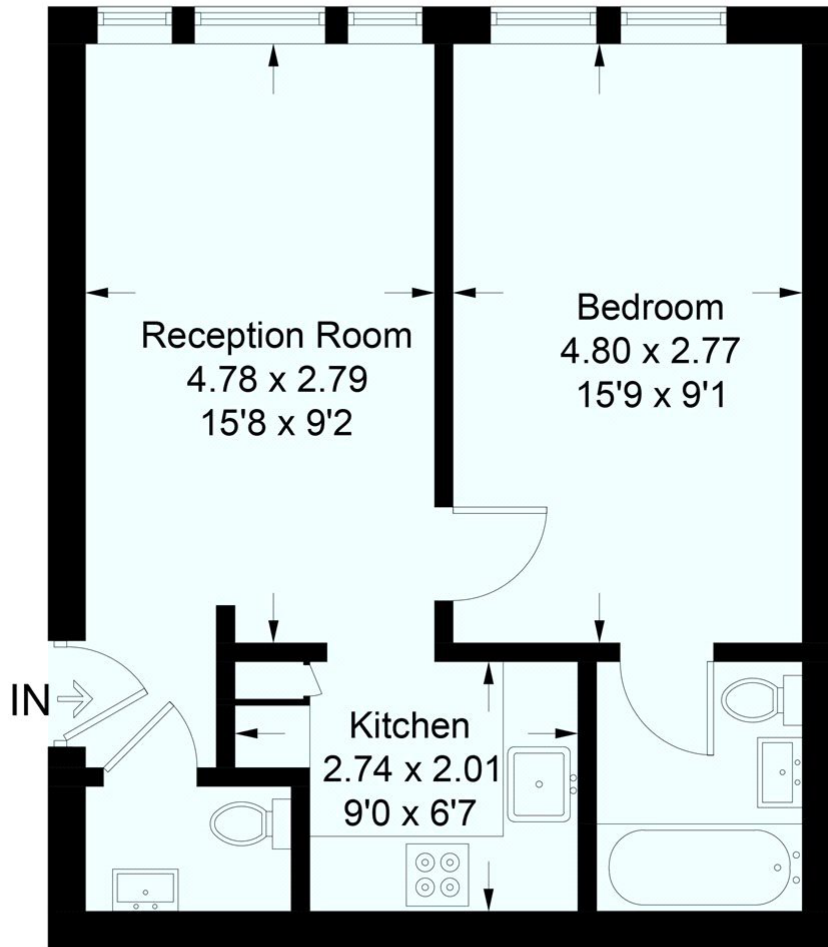

Ground Floor

This plan is for layout guidance only. Not drawn to scale unless stated. Windows and door openings are approximate. Whilst every care is taken in the preparation of this plan, please check all dimensions, shapes and compass bearings before making any decisions reliant upon them. (ID315345)

This floorplan is for illustration purposes only and is not to scale. The position and size of doors, windows, appliances and other features are approximate.

Energy Efficiency Rating		Current	Potential
Very energy efficient - lower running costs			
(92-)	A		
(81-91)	B	84	85
(69-80)	C		
(55-68)	D		
(39-54)	E		
(21-38)	F		
(1-20)	G		
Not energy efficient - higher running costs			
England, Scotland & Wales		EU Directive 2002/91/EC	

Herne Hill | 0207 501 8950 | hernehill@winkworth.co.uk



for every step...

winkworth.co.uk

Winkworth wishes to inform prospective buyers and tenants that these particulars are a guide and act as information only. All our details are given in good faith and believed to be correct at the time of printing but they don't form part of an offer or contract. No Winkworth employee has authority to make or give any representation or warranty in relation to this property. All fixtures and fittings, whether fitted or not are deemed removable by the vendor unless stated otherwise and room sizes are measured between internal wall surfaces, including furnishings.