

WORCESTER POINT, LONDON, EC1V
£800,000 LEASEHOLD APPROX 138 YEARS REMAINING

Winkworth



WORCESTER POINT, LONDON, EC1V

A very spacious two bedroom two bathroom flat on the second floor of this modern and sought after residential development close to the City.

Flooded with natural light, the flat has the sole use of a south facing private terrace leading off a large reception. Offered in very good condition throughout, there are two very good size double bedrooms, both with in-built storage and one with an en-suite.

There is the added benefit of under floor heating, a separate utility cupboard and a designated off-street car parking space.

Worcester Point has an onsite concierge, secure bicycle storage, a well maintained/peaceful courtyard and large communal roof terrace with impressive views of the City. Old Street, Angel, Farringdon (impending Crossrail) and Barbican stations are all within easy reach.

Leasehold Approx. 138 Years Remaining
Service Charge Approx. £3,508p/a
Ground Rent Approx. 510p/a
Council Tax Band: F



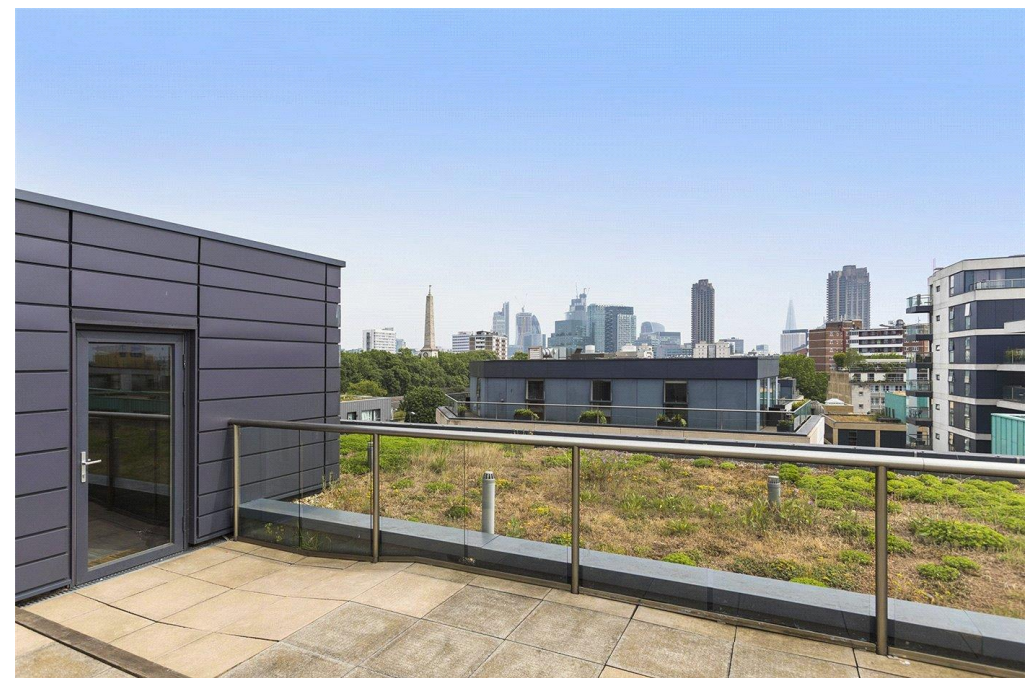

Worcester Point, Central Street
London, EC1V



Winkworth

Approx Gross Internal Area **826 Sq Ft - 77.00 Sq M**

Whilst every attempt has been made to ensure the accuracy of the floor plan contained here, measurements of the doors, windows, rooms and any other items are approximate and no responsibility is taken for any error, omission, or mis-statement. This plan is for illustrative purposes only and should be used as such by any prospective purchaser. The services, systems and appliances shown have not been tested and no guarantee as to their operability or efficiency can be given.

Clerkenwell & City | 020 7405 1288 | clerkenwell@winkworth.co.uk

winkworth.co.uk

Winkworth wishes to inform prospective buyers and tenants that these particulars are a guide and act as information only. All our details are given in good faith and believed to be correct at the time of printing but they don't form part of an offer or contract. No Winkworth employee has authority to make or give any representation or warranty in relation to this property. All fixtures and fittings, whether fitted or not are deemed removable by the vendor unless stated otherwise and room sizes are measured between internal wall surfaces, including furnishings.

Winkworth