



TRENTHAM COURT, W3  
£300,000 LEASEHOLD

Lease: 980 years remaining  
Service Charge: £1,600 per annum  
Ground Rent: £225 per annum  
*(Information supplied by the Seller)*

EPC Band: C  
Council Tax Band: D

Ealing & Acton | 0208 896 0123 | ealing@winkworth.co.uk

**Winkworth**

for every step...

*winkworth.co.uk*



## DESCRIPTION:

Situated within a modern development, the apartment is located on the 9th floor and offers stunning views across London! It comprises a spacious open-plan reception room with fully-equipped kitchen, double bedroom with built-in wardrobes and a modern family bathroom. The property further benefits from concierge service, lift access and landscaped gardens.

The building is just moments away from North Acton station (Central Line) and commuters also benefit from being within easy reach of Acton Main Line station (Elizabeth Line) whereas motorists can easily get into Central London via the A40 Westway. Residents also benefit from various amenities at their doorstep.



**Winkworth**

for every step...





**Winkworth**

for every step...

# Trentham Court, W3

Approx. Gross Internal Area 464 Sq Ft - 43.11 Sq M

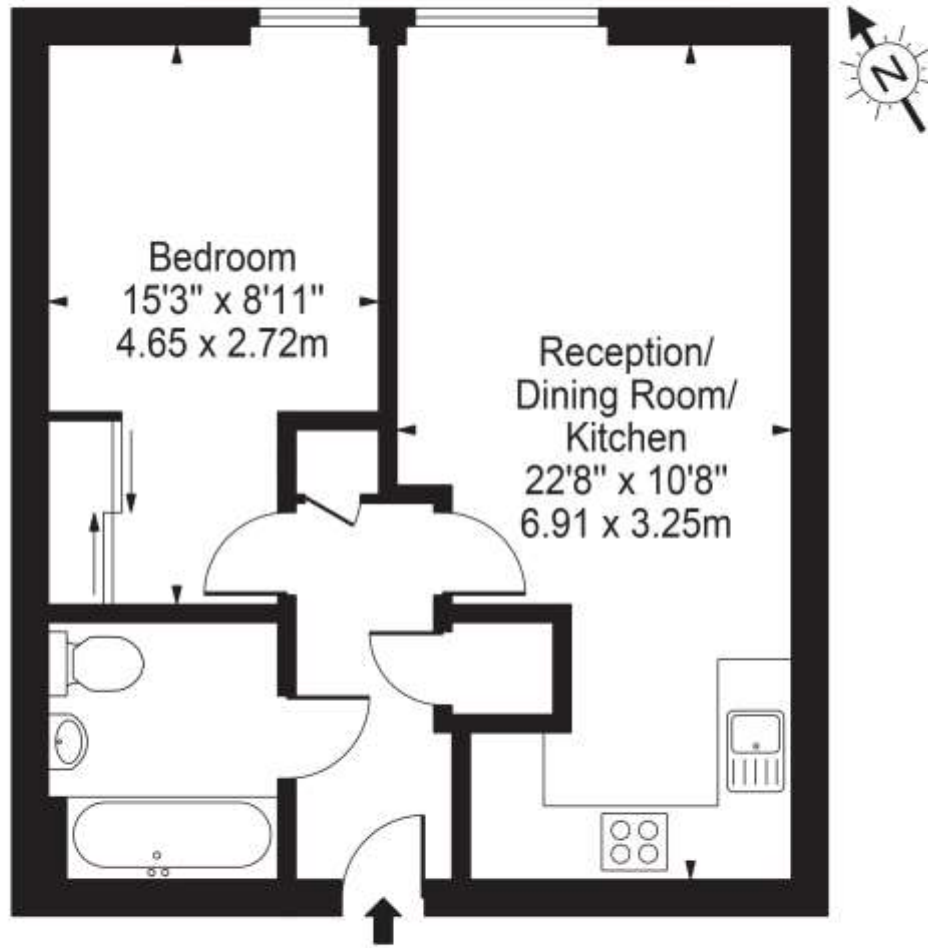

Ninth Floor

For Illustration Purposes Only - Not To Scale Floor Plan by Mira Nikolova Photography

This floor plan should be used as a general outline for guidance only and does not constitute in whole or in part an offer or contract. Any intending purchaser or lessee should satisfy themselves by inspection, searches, enquiries and full survey as to the correctness of each statement. Any areas, measurements or distances quoted are approximate and should not be used to value a property or be the basis of any sale or let.

This floorplan is for illustration purposes only and is not to scale. The position and size of doors, windows, appliances and other features are approximate.

Tenure: Leasehold

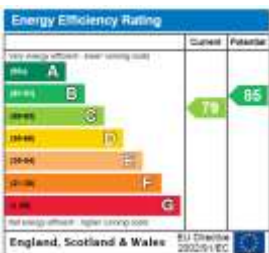

Ealing & Acton | 0208 896 0123 | ealing@winkworth.co.uk



for every step...

winkworth.co.uk

Winkworth wishes to inform prospective buyers and tenants that these particulars are a guide and act as information only. All our details are given in good faith and believed to be correct at the time of printing but they don't form part of an offer or contract. No Winkworth employee has authority to make or give any representation or warranty in relation to this property. All fixtures and fittings, whether fitted or not are deemed removable by the vendor unless stated otherwise and room sizes are measured between internal wall surfaces, including furnishings.