



Waterton Way, Bishops Tachbrook, Warwickshire, CV33

**Offers Around £500,000 Freehold**

A beautifully presented, four-bedroom detached family home offering modern living within easy reach of Leamington Spa and Warwick.

Leamington Spa | 01926 956560 | leamingtonspa@winkworth.co.uk

Nick Martiny Roberts | Director | nmartinyroberts@winkworth.co.uk

**Winkworth**





## DESCRIPTION

Winkworth Leamington Spa is pleased to present to the market this beautifully presented, four-bedroom, detached family home offering modern living within easy reach of Leamington Spa.

Upon entering the property, a spacious entrance hall provides access to a sitting room and separate dining room/snug, both of which enjoy a front aspect and plenty of natural light. The modern kitchen diner, has a range of built in appliances and a breakfast bar, with double patio doors leading into the rear garden and terrace from the panelled dining area. A separate utility room leads off from the kitchen and provides access to a WC/cloakroom.

On the first floor a generous landing provides access to the four double bedrooms and a family bathroom. The master bedroom has the added benefit of an en-suite shower room.

Externally, the property has a well maintained front garden, which wraps around to a detached garage and tarmac driveway, providing ample off street parking and storage. The rear garden has a large patio which is ideal for entertaining, the remaining garden is fully enclosed and turfed.

## AT A GLANCE

Council Tax: Band F  
 Local Authority: Warwick District Council  
 Broadband: Ultrafast Broadband Available  
 (Checked on Ofcom Sept 24)  
 Mobile Coverage: Limited/Likely Coverage  
 Heating: Gas Central Heating  
 Listed: No  
 Tenure: Freehold

Energy Efficiency Rating		
	Current	Potential
Very energy efficient - lower running costs		
(92+) <b>A</b>		94
(81-91) <b>B</b>	84	
(69-80) <b>C</b>		
(55-68) <b>D</b>		
(39-54) <b>E</b>		
(21-38) <b>F</b>		
(1-20) <b>G</b>		
Not energy efficient - higher running costs		
<b>England, Scotland &amp; Wales</b>	EU Directive 2002/91/EC	





## LOCATION

Situated in the desirable Bishops Gate development in Bishops Tachbrook, Waterton Way is a quiet cul-de-sac close to the fantastic transport links, good schools and gardens of Leamington Spa and Warwick.

There are excellent schools within easy reach of Waterton Way including Heathcote Primary School, Myton School, Arnold Lodge School, Warwick School and Kings High School for Girls, while there is a new secondary school being built locally.

For the commuter, Leamington Spa and Warwick Parkway train stations provide direct trains into London Marylebone and Birmingham. The motorway system is accessible by various local junctions of the M40 and also provides access to London, Birmingham and further afield.

# Waterton Way

Approximate Gross Internal Area  
1245 sq ft - 115 sq m

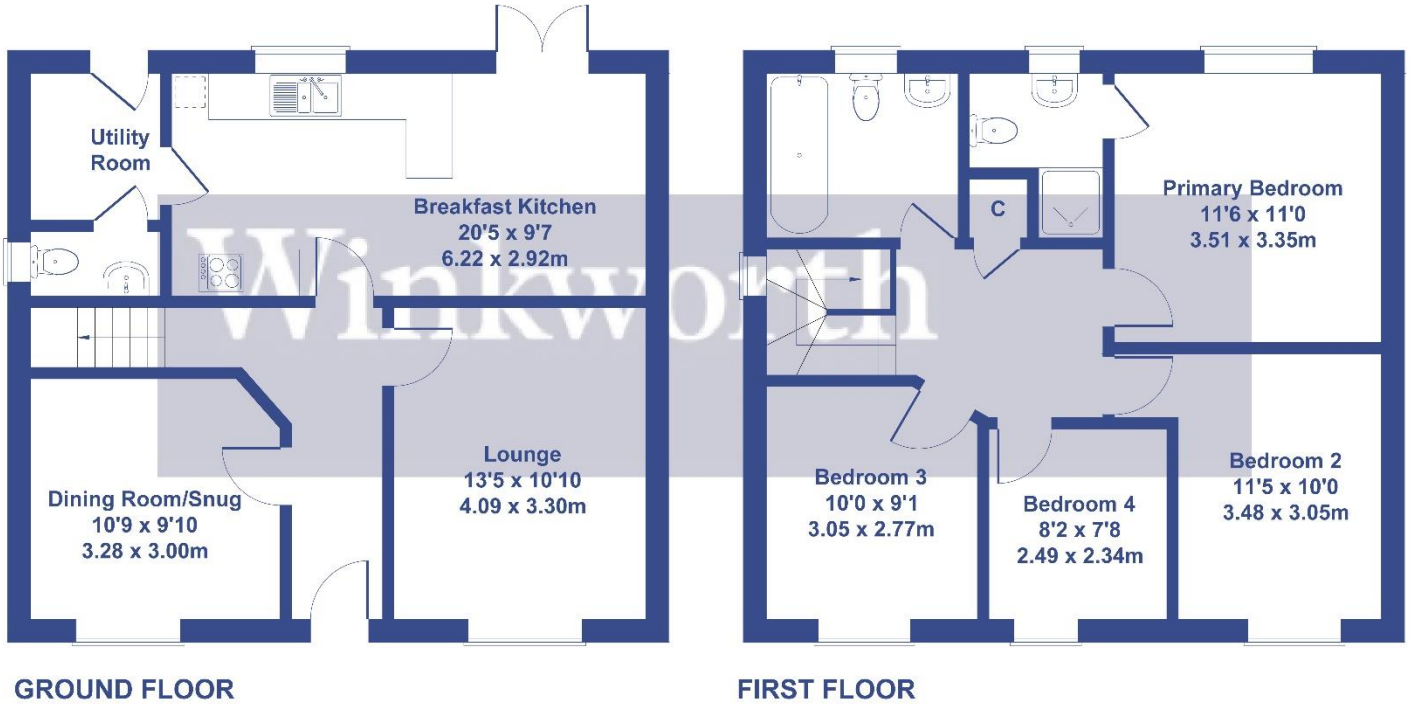

Not to Scale. Produced by The Plan Portal 2024  
For Illustrative Purposes Only.

**COUNCIL TAX-** Band F  
**LOCAL AUTHORITY -** Warwick District Council

NOTICE: Whilst every effort has been made to ensure the accuracy of these sales details, they are for guidance purposes only and prospective purchasers are advised to seek their own professional advice as well as to satisfy themselves by inspection or otherwise as to their correctness. No representation or warranty whatsoever is made in relation to this property by Winkworth or its employees nor do such sales details form part of any offer or contract.