



## **KENSINGTON GARDENS SQUARE, W2**

**£775,000 SHARE OF FREEHOLD (999 YEARS REMAINING)**

**A VERY GRAND FIRST FLOOR, STUDIO FLAT, EXTENDING TO 611SQ.FT WITH MAGNIFICENT PROPORTIONS AND WONDERFUL VIEWS OVER KENSINGTON GARDENS SQUARE.**

**1 Reception Room, 1 Bathroom, Flat/Apartment, Studio, Communal Gardens, Period, 611 Approx Sq Ft, Service Charge £2,300 p/a, Ground Rent Peppercorn p/a**

**Winkworth**

Notting Hill Sales | 0207 727 3227 | nottinghill@winkworth.co.uk

*winkworth.co.uk*

for every step...



### **DESCRIPTION:**

This impressive flat is situated on the first floor of an imposing period building and extends to 611 sq.ft. Currently laid out as a studio, with a bathroom to the rear, the flat makes the most of the grand proportions of a first floor in a period conversion. A large window to the front provides far reaching views across the private communal garden square. Subject to the necessary consents the flat could be converted into a one bed.

### **LOCATION:**

Kensington Gardens Square is an impressive garden square, running south from Westbourne Grove with its many shops and restaurants, and just to the east Queensway with its many amenities and transport links and current extensive regeneration programme.

### **LOCAL AUTHORITY AND COUNCIL TAX BAND:**

City of Westminster (Band E)



# Kensington Gardens Square W2 4BH

Approx Gross Internal Area = 56.8 sq m / 611 sq ft

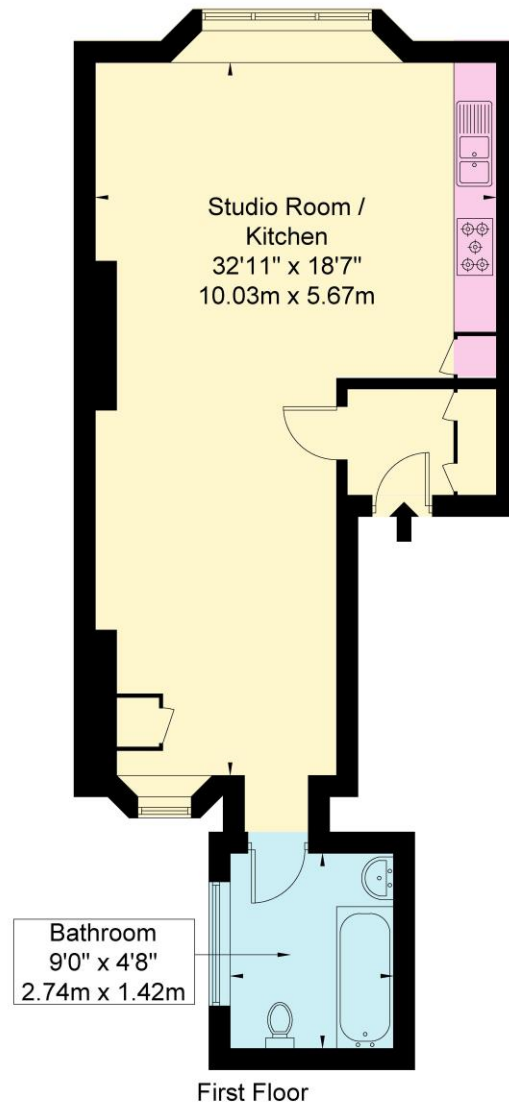
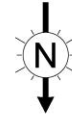

First Floor

Ref

Copyright **BLEUPLAN**

The Floor plan is not to scale and measurements and areas shown are approximate and therefore should be used for illustrative purposes only. The plan has been prepared in accordance with the RICS code of Measuring Practice and whilst we have confidence in the information produced it must not be relied on. If there is any aspect of particular importance, you should carry out or commission your own inspection of the property.  
Copyright @ BLEUPLAN

This floorplan is for illustration purposes only and is not to scale. The position and size of doors, windows, appliances and other features are approximate.

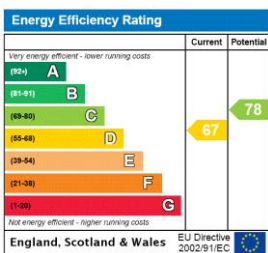

Notting Hill Sales | 0207 727 3227 | nottinghill@winkworth.co.uk



winkworth.co.uk

for every step...

winkworth wishes to inform prospective buyers and tenants that these particulars are a guide and act as information only. All our details are given in good faith and believed to be correct at the time of printing but they don't form part of an offer or contract. No Winkworth employee has authority to make or give any representation or warranty in relation to this property. All fixtures and fittings, whether fitted or not are deemed removable by the vendor unless stated otherwise and room sizes are measured between internal wall surfaces, including furnishings.