



5 Withy Close, Romsey, Hampshire, SO51 7SA

Winkworth



WONDERFUL FOUR BEDROOM FAMILY HOME IN ROMSEY

This lovely property is situated in a quiet and peaceful location within easy walking distance of the town centre. Fishlake Meadows is one of the most popular developments in Romsey, for its close proximity to Romsey town centre via a charming, canal side walk. Romsey is a delightful old market town that has retained much of its original character and provides an excellent range of amenities for everyday needs including shops, schools, doctors and dentist surgeries, restaurants and public houses. The commercial centres of Southampton, Salisbury and Winchester are easily accessible via major road and railway links, with the station being a small walk away. There are a number of sporting facilities locally including The Rapids Leisure Centre and the New Forest National Park is within 6 miles of Romsey.

This well-presented family home is in a secluded location on the outskirts of Romsey in the ever-popular Fishlake Meadows. Comprising a welcoming entrance hall leading to all principal ground floor rooms including a well-presented kitchen/breakfast room, fitted with a comprehensive range of modern eye and base level units. Adjacent to the kitchen is an ever-useful utility room which provides access to the rear garden. A separate dining room offers more formal dining or could be utilized as a playroom or home office. The sitting room is of good proportions and features French doors that open onto the rear garden. A cloakroom and large storage cupboard complete downstairs. To the first floor are four bedrooms. The master bedroom benefits from an en-suite shower room whilst the remaining bedrooms are serviced by a family bathroom.

To the front the block paved driveway provides ample parking and leads to a detached single garage. The rear garden is private and well maintained, primarily laid to lawn with a patio area and bordered with well-established plants and shrubs.

- EPC – C
- All Mains utilities
- Council Tax Band - E
- No onward chain



Winkworth

Address: 5 Withy Close, Romsey,
Hampshire SO51 7SA

Council Tax Band: E

EPC: C

Tenure: Freehold



OUTBUILDING
18.2 sq.m. (196 sq.ft.) approx.

GROUND FLOOR
62.9 sq.m. (677 sq.ft.) approx.

1ST FLOOR
55.2 sq.m. (594 sq.ft.) approx.

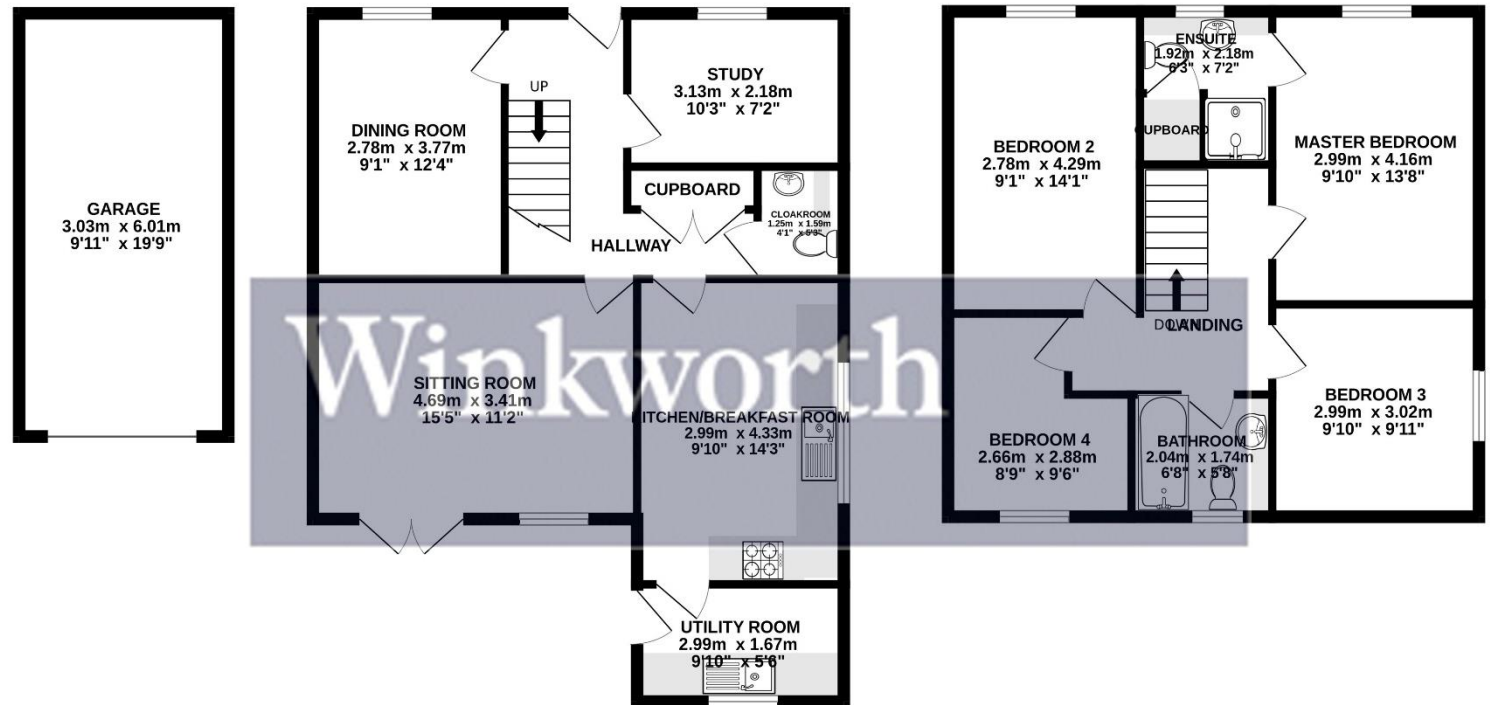

TOTAL FLOOR AREA : 136.3 sq.m. (1467 sq.ft.) approx.

DISCLAIMER: This information has been prepared as guide only. The vendor and Estate Agents, make no warranties as its accuracy and all interested parties must rely on their own enquiries.
Made with Metropix ©2023

winkworth.co.uk/romsey

Winkworth Romsey

18 Market Place, Romsey, Hampshire, SO51 8NA
01794 511911 | romsey@winkworth.co.uk

winkworth.co.uk/romsey

Winkworth Winchester

2 Black Swan Buildings, Southgate Street,
Winchester, Hampshire, SO23 9DT
01962 866777 | winchester@winkworth.co.uk

Winkworth Mayfair & Country House Department

11 Berkeley Street, Mayfair, London, W1J 8DS
020 7871 0589 | countryhouse@winkworth.co.uk

Winkworth

See things differently