



## Gloucester Street, UK, SW1V

£2,500 PER MONTH

FURNISHED

### AT A GLANCE

- Two Double Bedrooms
- Reception Room
- Period Conversion
- Excellent Location
- Council Tax Band: E

**Winkworth**

for every step...



Energy Efficiency Rating		
	Current	Potential
Very energy efficient - lower running costs		
(92+) <b>A</b>		
(81-91) <b>B</b>		
(69-80) <b>C</b>		79
(55-68) <b>D</b>	65	
(39-54) <b>E</b>		
(21-38) <b>F</b>		
(1-20) <b>G</b>		
Not energy efficient - higher running costs		
England, Scotland & Wales	EU Directive 2002/91/EC	

## GLOUCESTER STREET, UK, SW1V

£2,500 PER MONTH

FURNISHED

This charming property comprises a bright reception room semi open-plan to the kitchen, two double bedrooms with good storage and bathroom with shower over bath.

### Gloucester Street, SW1



Approx. Gross Internal Area  
506 Sq Ft - 47.01 Sq M

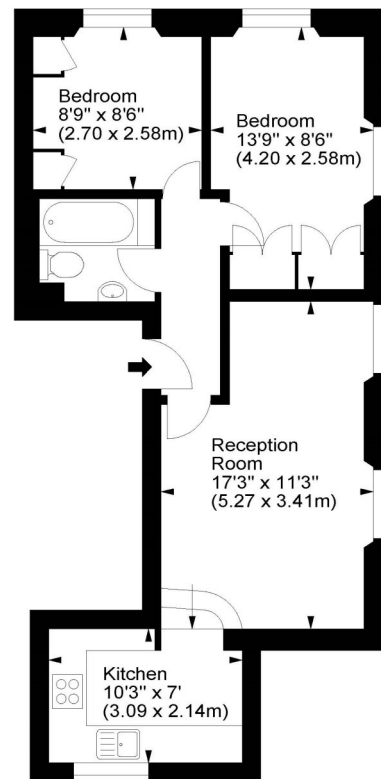

Second Floor

For illustration purposes only. Not to scale.  
All measurements are taken and shown at floor level.  
[www.r3photography.co.uk](http://www.r3photography.co.uk) © Photography / Floor Plans / Lease Plans / EPCs

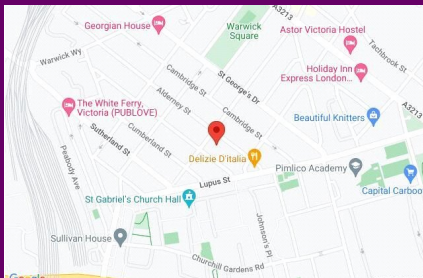

winkworth wishes to inform prospective buyers and tenants that these particulars are a guide and act as information only. All our details are given in good faith and believed to be correct at the time of printing but they don't form part of an offer or contract. No winkworth employee has authority to make or give any representation or warranty in relation to this property. All fixtures and fittings, whether fitted or not are deemed removable by the vendor unless stated otherwise and room sizes are measured between internal wall surfaces - including fireplaces.

Pimlico & Westminster | 020 7828 1786 |  
[pimlico@winkworth.co.uk](mailto:pimlico@winkworth.co.uk)

[winkworth.co.uk/pimlico](http://winkworth.co.uk/pimlico)

# Winkworth

for every step...