



Delkeith Court

91 Dudsbury Avenue, Ferndown BH22 8DY

Guide Price £250,000

Winkworth



GUIDE PRICE £250,000
SHARE OF FREEHOLD

*****VACANT POSSESSION****

This very spacious two double bedroom first floor apartment has been well maintained throughout and is located in a quiet & popular residential location just a short stroll from Ferndown town centre. The property benefits from a single garage, a long lease of 987 years and vacant possession with no onward chain.



01202 434365
ferndown@winkworth.co.uk



KEY FEATURES

987 Year Lease
Share Of Freehold
Two Double Bedrooms
Over 800 Sq Ft
First Floor
Single Garage
Off Road Parking
Communal Gardens
No Onward Chain
Short Walk From High Street
Close To Amenities
Excellent Storage
EPC C
COUNCIL TAX BAND D

Delkeith Court

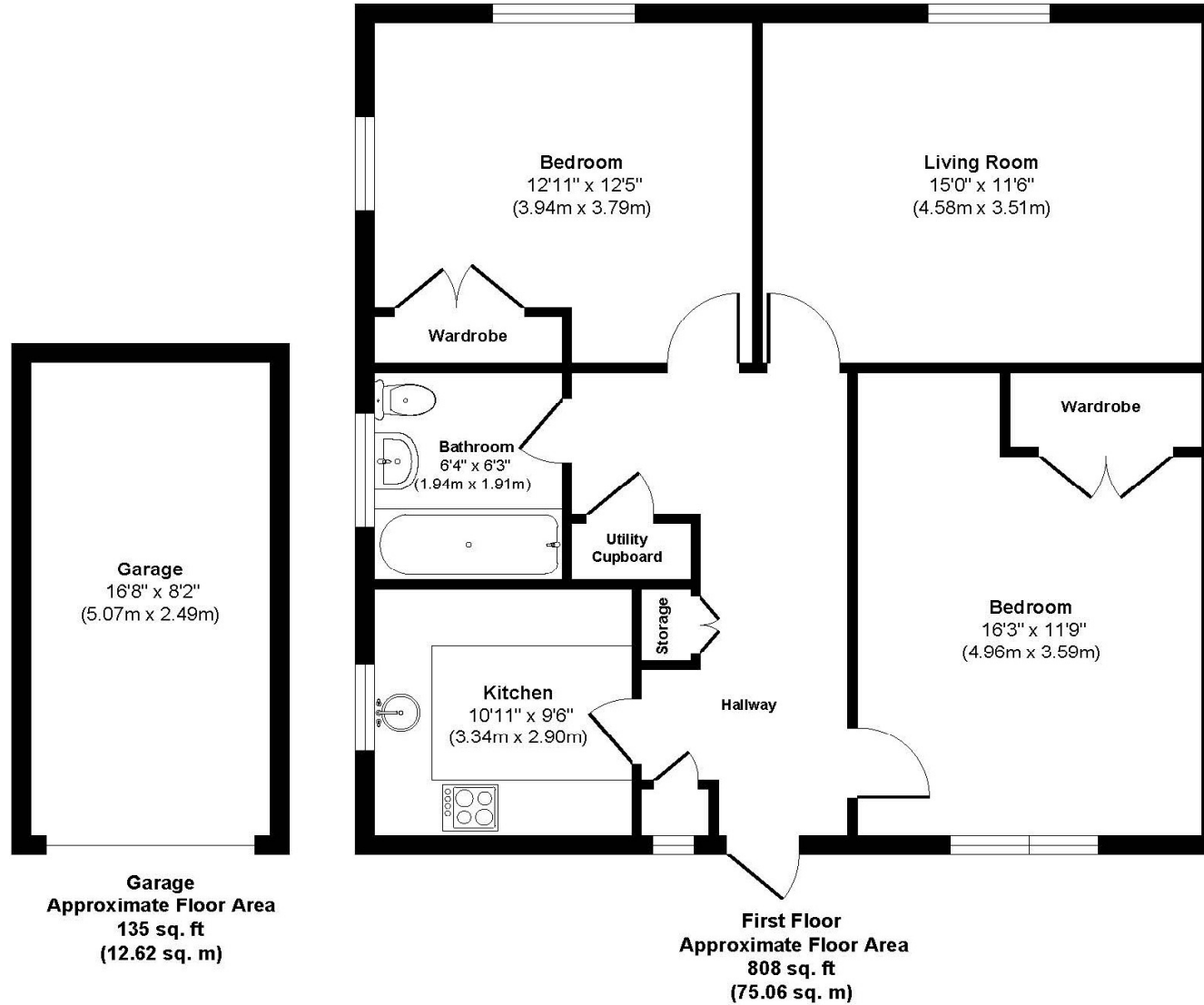

Approx. Gross Internal Floor Area 943 sq. ft / 87.68 sq. m (including garage)
Illustration for identification purposes only, measurements approximate and not to scale.



LOCATION

Less than a five minute walk from Ferndown town centre, which has a range of shops, cafes and amenities including an M&S Foodhall. Ferndown championship Golf Course is within close proximity and there are bus routes nearby giving you easy access to Bournemouth, Poole & Wimborne all of which have an excellent range of shops, restaurants and leisure facilities. Award winning sandy beaches are just twenty minutes away and the A31 provides quick access to the New Forest, Southampton and London.

Winkworth Ferndown

406 Ringwood Road, Ferndown, Dorset, BH22 9AU

01202 434365 | ferndown@winkworth.co.uk

winkworth.co.uk/ferndown

Winkworth